

D.A. MANDER & SON Ltd

PROFESSIONAL FITTER AND
SUPPLIER OF QUALITY CARPETS

*Don Mander does not have retail premises. If you need him
please call him direct – the only way to buy carpets*



Need a carpet?

Support the NHS
Stay at home and stay safe

We come to you

ACCURATE

*See colours in their
true light*

CONVENIENT

*View in the comfort of
your own home*

EASIER

*Than walking round
lots of shops*

01564 700200

We can uplift and remove existing carpets and move furniture

Mobile: 07976 778694

FREE ESTIMATES

91 Longdon Road, Knowle B93 9HT

See our Review's at

Google



Yell

Freeindex

N.BIRD & SON

ROOFING SERVICES



FREE QUOTES

EST 1987 SOLIHULL BASED

- Small Repairs
- Flat Roofs
- New Roofs
- Ridge Tiles
- Chimney Work
- Lead Work
- UPVC Facia, Soffit & Gutters
- GRP Flat Roofs

0121 743 6324

LOCAL FAMILY RUN BUSINESS



249 Lyndon Road, Solihull B92 7QP



NO PAYMENT UNTIL YOU ARE 100% SATISFIED

Knowle Domestic Plumbing Service & Appliance Repairs

All Plumbing Work Undertaken

- ***Burst pipes/leaks***
- ***Taps, Sinks, Waste Units***
- ***Ball Valves, Overflows***
- ***Tanks, Cylinders,
Immersion***
- ***Toilets, baths,
Showers***
- ***24 Hour Emergency***

Appliance Repair Services

- ***Washing Machines***
- ***Dishwashers***
- ***Tumble Dryers***
- ***Electric cookers***
- ***Vacuum Cleaners***

£10 OFF for first time customers with this ad.

Valid until: 10th December 2021

***12 month guarantee, same day call-out
special rates for OAP's***

Office: 01564 730183

Mobile: 07770 698196

Support local

Welcome to the November edition...

By the time this arrives Christmas will only be about 6 weeks away! Check out page 6 to see what local events are coming up, including Solihull's very own Jingle Bell Jog!

You've just about got time to make any last-minute changes to your home in time for Christmas so remember to support local businesses as they really value their customers – we have a great collection of local tradespeople and businesses who are local and are looking for your custom. Here's hoping the pre-Christmas build up isn't too hectic and that you find the time to relax, maybe over a glass of mulled wine and a mince pie!

Fancy winning a bottle of Prosecco?!

Just scan the QR code below to be entered into our free prize draw. All you need to do is submit a Google review of the magazine and we'll draw a winner at random and deliver a bottle to your door!*



Zoe Reece

Tel: 07557 220585

Email: zoe@dorridgedirectory.com

www.knowleanddorridgedirectory.com

contents

- 6** Events
- 28** Book reviews
- 30** Competition
- 34** Recipe
- 40** Puzzles
- 44** Useful telephone numbers
- 45** Index



*** Google reviews** must be received by 10th December 2021. To qualify you will need to email zoe@dorridgedirectory.com after you have submitted a review with your name, telephone number, and address (which must be in the B90 or B91 postcode).

Locally designed by: hotlobster design ltd **Printed by:** Norwood Press

PLEASE RECYCLE THIS MAGAZINE



Live Safe and Well

Avery Healthcare is a leading and award-winning national care home provider offering residential, respite, nursing and dementia care.

- Nutritionally balanced seasonal menus • Spacious, beautifully decorated bedrooms
- A warm and friendly environment to make new friends • Safe visits for family and friends
- Stimulating schedule of daily activities and entertainment • Highly trained staff teams

For the best in Solihull, look no further.

Birchmere House
01564 621393

Birchmere Mews
01564 621701

Knowle Gate
01564 621012



community events

Coffee & Cake at Cobbles

20 November from 10am

Knowle Parish Church

Pop in for a warm welcome, friendly service, and company. We open every Saturday in the Guild House from 10am. A great place to catch up with friends over coffee and cake! Email office@kpc.org.uk for more information.

Bon Jovi & Bryan Adams tribute night

Knowle Royal British Legion

20 November, 7pm

Bon Jovi & Bryan Adams Tribute Experience performing the very best hits of Bon Jovi and Bryan Adams in one fantastic show! You Give Love A Bad Name, Run To You. Bad Medicine, Heaven. Living On A Prayer & Summer Of '69 plus much more. Visit skiddle.com for tickets

A Christmas Fair

Knowle Village Hall

Saturday 27 November

10am – 1pm

Browse through Christmas cards, gifts, cakes and preserves, decorations, books, bric-a-brac and more. There will be competitions and refreshments. This is a Knowle Village Hall fundraising event.

Solihull's Jingle Bell Jog

Solihull

12 December

Join Solihull BID to spread plenty of festive cheer this December by donning a Santa suit and



completing the Jingle Bell Jog to raise money for homeless charity Change Into Action. Run, walk, dance, jog or jingle your way around our family-friendly 2.5km fun run through Solihull town centre. To book: www.solihullbid.co.uk/events/solihulls-jingle-bell-jog-2021/

Rats In The Kitchen (Tribute to UB40)

Land Rover Sports &

Social Club Solihull

New Year's Eve 31/12/2021

From Birmingham, the home city of reggae giants UB40, Rats In The Kitchen are the world's number 1 UB40 Tribute Show. This fully live, eight piece band, will perform up to 3 hours of pulsating reggae hits now spanning more than 25 years! Adults only. Tickets £32.50 in advance only, including buffet. Book at www.landroversc.co.uk

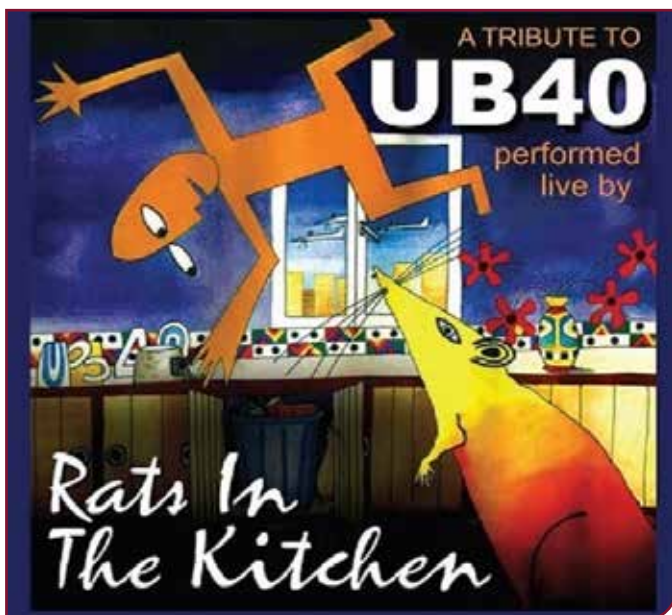



Beautiful Interior Doors Supplied and Installed



www.acsinteriordoors.co.uk

Come and visit our NEW showroom in Studley

Unit 1,
Haydon House,
Alcester Road,
Studley
B80 7AN

07592 303104 or
07910 289565

YOUR LOCAL BLINDS, CURTAINS & SHUTTERS SPECIALIST

✓ Friendly local service ✓ Options for every budget ✓ Price includes measuring & fitting



- I provide expert advice on the best window solutions
- Flexible appointment times
- Over 1000 fabrics & styles to choose from
- Blinds & curtains made right here in the UK
- Ask me about multi-blind discounts
- I won't be beaten on price*

ROLLERS | ROMANS | VERTICALS | VENETIANS | CURTAINS | SHUTTERS | WOODEN BLINDS

Call me for a free in-home appointment:

Chris Gaite 07738990211

*Based on the same spec, size & levels of service.

HILLARYS
Solihull

OAKLAND



GROUP

Service Quality Value

Professional Outdoor Services



Tree Surgery & Hedging



Landscaping

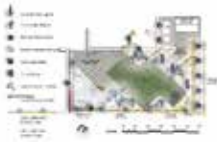

Garden/Lighting
Design



Porcelain Garden



Fencing



Planting &
Irrigation



Outdoor Lighting



Borders &
Maintenance



Visit us at Rosebourne Garden Centre
Kenilworth Rd, Hampton in Arden,
Solihull, B92 0LP

01564 758 608

www.oaklandgroupuk.com

www.12vgardenlights.com

info@oaklandgroupuk.com



Stephen Smith & Son Plumbing & Heating Services



Accredited
Installer



Gas Safe reg no: 198187
Natural Gas, LPG & Oil



**Tel: 0121 247 4957
or 01564 200119**

**10 years Manufacturer's Warranty
on all Worcester Greenstar
gas boilers installed***

www.stephensmithandson.co.uk

"Family business. Local and reliable."

Work carried out includes:

- Boilers / Radiators
- Natural Gas - LPG and Oil Installation and Repair
- Landlord Gas Safety Inspections/Certificates
- Boiler Servicing
- Hot Water Cylinders (vented and unvented)
- System Powerflushing
- Cold Water Tanks
- Shower Installations / Repairs
- Pipework
- Underfloor Heating

*Worcester Bosch terms apply



For your **FREE** quotation please contact
React Roofing today!

- NEW ROOF SPECIALISTS
- FASCIAS, SOFFITS & GUTTERING
- FLAT ROOF SPECIALISTS
- GRP FIBRE GLASS ROOFING
- LEAD WORK
- CHIMNEY REPAIRS & BUILDS



Tel: 07922 230 477

Email: reactroofingservices@gmail.com

www.reactroofingservices.co.uk
Based in Solihull

All aspects of arboriculture work undertaken.

Pruning, thinning, reshaping, crown lift, reductions, removals and stump removal.

- All hedge work
- All waste removed
- All work guaranteed to the highest industry standards
- Fully insured
- Free advice and quotations
- NTPC Qualified Workforce



COVID-19 UPDATE:

We are still working – safely and in line with Government guidelines regarding social distancing

Freephone: 03335 775733

Mobile: 07786 527 729

Email: info@solihulltreecare.com www.solihulltreecare.com

Cullen

Plumbing & Tiling

17 Whitacre Rd, Knowle
cullenplumbingandtiling@gmail.com

Tel: 07896 862 916

Established in 2005

City & Guilds

Qualified

- Full bathroom and ensuite design and installation to the highest standards with complete project management from start to completion
- Kitchen Sinks and Taps, Dishwasher and Washing Machine Installation
- Central Heating & Radiators
- General Plumbing Maintenance & Repair
- Showroom Finish Wall & Floor Tiling for bathrooms, kitchens, hallways and conservatories
- Specialist in ceramic, porcelain, natural stone tiling
- Business built on recommendation and reputation

All Work Guaranteed

Reliable Honest Service

References and Portfolio of Work Available



Call Alex Cullen

NOW on 07896 862 916

For a free no-obligation quotation

If I Only Had a Moustache!

It's Movember!

So sings the character Marcus Thornton in the film *A Million Ways to Die in the West*. If you haven't seen the clip on YouTube, watch it and give yourself an ear worm for the whole of Movember! You're welcome.

The Movember movement started in Australia in 2003. Travis Garone and Luke Slattery came up with the idea (over a beer of course). It began as a jokey way of trying to bring the moustache back into fashion. Inspired by a friend's mother who was fundraising for breast cancer, they decided

to make generate a campaign for men's health and prostate cancer. They designed the rules of Movember, which remain unchanged today, and agreed to charge ten dollars to 'Grow a Mo'. Trav designed the first Movember logo, and they sent out an email, subject: 'Are you man enough to be my man?' and found 30 volunteers.

In 2004 they formalised the idea, registered a company and created a website.

They researched men's health issues and agreed to formally support prostate cancer as their cause. By 2006 the Movember Foundation was established as an official Australian charity. They also started to branch out into supporting male mental health. The following year Movember started to grow internationally. There are now official campaigns in 21 countries and together they have raised around 350 million pounds and supported more than 1,000 men's health programs. They focus on the four key men's health issues: prostate cancer, testicular cancer, poor mental health, and physical inactivity.



So, what are the rules.

- The first step is simply registering on Movember.com.
- Start with a clean-shaven, including your upper lip, sideburns, and handlebar zones.
- For the entire month of Movember, you must grow and groom a moustache
- Beards, goatees and fake moustaches don't count
- Use the power of the moustache to create conversation and raise funds for men's health
- Each Mo Bro must conduct himself like a true gentleman

Personal wrapping • Corporate wrapping
Wedding favours

Banana Leaf

ECO GIFT WRAPPING



Need a helping hand?

info@banana-leaf.co.uk

07842 759266

www.banana-leaf.co.uk

GIFT WRAPPING THAT DOESN'T COST THE EARTH

Get the Study Habit!

Introduce good study habits to your child which will pay off all through their time in education.

Routine: Get into a homework routine as soon as possible. Immediately after school is good, after they've had a snack and a drink, as they will still be in the right frame of mind. Find out what works best for your child though. Some may need to expend pent-up energy first; others may need to chill for twenty minutes.

'Worst first': When mental energy is high work on the most difficult subject. Don't try to cram too many subjects into one session.

Talk: Encourage your child to talk through any projects with you first. Your child is then more likely to get the work right and won't get frustrated. Gently ask questions about any areas they seem unsure about and what materials or preparation they might need to undertake.

Study station: Designate an area for home learning. Make it as uncluttered and distraction-free as possible. Ensure all equipment required is nearby, so there's no stalling.

No TV: Anything with a screen should be switched off until after studying. Use it as a bribe if necessary. No games or TV until homework is completed!

The earlier your child gets into a routine the easier homework will become...for both of you.



Are Pre-nups just for the **Super rich**?

They aren't considered to be particularly romantic, but a prenuptial agreement (pre-nup) is a way of protecting your assets, should your marriage or civil partnership breakdown.

Dipika Mistry, Legal Director at Shakespeare Martineau in Solihull explains.

A lot of people think that pre-nups are only for millionaires and lottery winners, but they are becoming more and more important as people enter blended families or marry later in life when assets are greater. If you have significantly more wealth than your partner, personally or via a business, or have children from a previous relationship you'd like to protect, then you should consider a nuptial agreement.

What is a pre-nup?

A pre-nup is a legal agreement between a couple, which sets out how finances or assets will be distributed, in the event of divorce. They can be used to ring-fence assets that one or both parties bring to a marriage, or be used to protect assets inherited during the marriage. Where possible they should be flexible, in order to deal with changes in the family such as children or illness – backed up by an up to date will.

Are pre-nups legally binding?

No. A pre-nup is not legally binding in English law, however, they are becoming increasingly upheld provided that they are entered into fairly and on a voluntary basis and both parties have received independent legal advice before doing so. Pre-nups do not overrule a court's decision on financial arrangements on divorce but they do carry some influence.

I'm already married – how can I protect my assets?

It is possible to record an agreement after marriage or civil partnership; these are called postnuptial agreements. Similar to a pre-nup they outline the decision reached between a couple in relation to what will happen to their finances, should it breakdown. Some couples who have already entered into a pre-nup choose to enter into a further post-nup to confirm the arrangements still stand. For the best chance of these agreements being upheld, as with a pre-nup, a post-nup must be entered into fairly, after independent legal advice.



For more information and support call 0121 705 8151
email dipika.mistry@shma.co.uk or visit www.shma.co.uk

Shakespeare Martineau Radcliffe House, Blenheim Court, Solihull, B91 2AA

Belmont @ Home provides bespoke home care services designed to fit perfectly to each individual.



For those who still wish to have their own familiar front door and stay at home safe in the knowledge someone is there to care, Belmont @ Home offers at home care services.

Unlike other home care services, Belmont @ Home care services are not rushed. Every individual benefits from the care team's time, attention, and care, no rushed visits, no clock watching,

just time for dedicated service.

At home care services should adapt to each individual need, mood and daily, weekly plans.

From personal care, organisation of social activities, attending to daily admin, housekeeping and preparing meals, or acting as chaperone to appointments, Belmont @ Home is there to support you!

Belmont @ Home care services flex to each individual because every day is different



Your first step towards personalised home care services starts with a free no obligation conversation with a Trusted Assessor to learn more about you and your needs.

To receive an initial assessment call us on 0121 295 8905



Because every day is different, Belmont @ Home will work to your needs and aspirations.

Join us for tailored home care services uniquely designed for you and your life.

www.belmonthealthcare.co.uk

☎ 0121 295 8905

✉ homecare@belmonthealthcare.co.uk



MIDLANDS
ULTRASOUND
& MEDICAL
SERVICES



MUMS is a **specialist Consultant-led** medical practice based in **Solihull, West Midlands** offering a number of medical services.

The Consultants and GPs at MUMS are proud to offer the highest standard of patient-centred healthcare.



Convenient unrushed appointments

- ✓ No need for a referral from your NHS GP
- ✓ No waiting times
- ✓ Unrushed appointments
- ✓ On site diagnostics

Specialist Consultants
GP's
Diagnostics
Ultrasound
Pregnancy Care

Antenatal Scans
Health Screening
Vaccinations
Sexual Health
Covid Testing

Trusted Excellence in Private Healthcare

Book an appointment with a
member of our dedicated team

Call. 0121 704 2669

Email. administrator@mums.me.uk

Clinic Address

Midland Ultrasound &
Medical Services
1 Park Avenue, Solihull,
West Midlands B91 3EJ



Follow us on Social Media



www.mums.me.uk

LEADING THE WAY IN LAWN CARE

SAVE UP TO

30%

ON OUR ULTIMATE
PROGRAMME*

*Save up to 30% with our
Ultimate Programme and
up to 18% with our Standard
Programme when you pay by
Direct Debit.

SAVE UP TO

18%

ON OUR STANDARD
PROGRAMME*

PREPARE YOUR LAWN NOW

Autumn is a very important season for your grass. Lush green lawns in spring don't just appear overnight, the preparation starts now.

Revolutionise your lawn with annual machine work paired with our unique **Spring Ready Treatment** applied from January - working wonders across the nation's lawns.

EVERY LAWN BENEFITS FROM MACHINE WORK

Lawns have a natural build-up of thatch. Thatch creates an environment irresistible to moss. **Aeration** and **Scarification** reduce thatch, thus reducing moss. **Simple!**

Annual machine work is essential for a healthy lawn. Autumn and spring are the best times of year for your grass to benefit from **Aeration & Scarification**. Our **Spring Ready Treatment** will then be waiting patiently for the optimal weather conditions before releasing its nutrients onto your lawn at the best possible time.



AERATION



SCARIFICATION

Book your machine work in today - your lawn will thank you for it!

Join our nation of Lawn Lovers today:

Call: 0121 705 6395

Email: solihull@greenthumb.co.uk

Visit: greenthumb.co.uk

**Only £895 for
a fully fitted
electric door.**

Gotta get a Garolla.



Garolla garage doors are strong and solidly built. They're made to measure in our own UK factories. The electric Garolla door rolls up vertically taking up only 8 inches inside your garage. Our expert installers will fit your new door and take away the old one so there's no mess.

Give us a call today and we'll come and measure up completely Free.

GAROLLA
ROLLER
SHUTTER
DOORS 
GOTTA GET A GAROLLA

NOW ONLY

£895 WAS £1,354
INC VAT

WHAT'S INCLUDED WITH EVERY DOOR:

FREE EXPERT MEASURING & FITTING
TWO REMOTE CONTROLS
ACOUSTIC & THERMAL INSULATION
AVAILABLE IN 21 COLOURS
FREE DISPOSAL OF YOUR OLD DOOR

Offer valid for openings up to
2.6m wide & inc: 2 remote
controls, 55mm white slats,
internal manual override.

CALL US TODAY

01564 340 013

MOBILE

07537 149 128

www.garolla.co.uk

Beech  **Languages**
LOCAL LANGUAGE LEARNING

**LOVE TO SPEAK GERMAN, FRENCH OR SPANISH?
NEW TO SOLIHULL AND NEED BETTER ENGLISH?**

All online courses of 10 hours (including GCSE 'catch-up') now just £299

Expert tuition for exams, travel and business
Local, qualified and experienced language tutors

Contact us now for your free, no-obligation consultation

Call 01564 739621 or 0784 031 5982

E-mail info@beech-languages.co.uk

www.beech-languages.co.uk

LANGUAGE LESSONS LOCALLY AND ONLINE



**Acorn Floors
Ltd.**

Floorcovering Specialists

Providing quality floorcoverings for over 25 years

**Luxury Vinyl Tiles
Carpets
Wet Room Solutions
Floor Refurbishment
Carpet Whipping**



**Karndean
Designflooring**

amtico

POLYFLOR™
COVERING THE WORLD

**The complete
design and
installation service**

10% OFF
with this advert

Free Quotation & Sample Service

acorn-floors.co.uk enquiries@acorn-floors.co.uk

Contact Stephen Sherrington

0121 693 3301 07799 645 709

Dimension Groundworks & Driveways

Specialists in Driveways and Landscaping

- Block paving • Tarmacing (red or black) • Patios
- Brickwork • Slabbing • Gravel • Landscaping
- Fencing • Property & roof repairs
- Driveway maintenance
(pressure cleaning & sealing – weed free)



07961 358367 / 0121 652 0145 / 01926 674782

dimensiongroundworks@icloud.com

www.dimensionpathways.co.uk

328 Alcester Road Wythall Birmingham West Midlands B47 6JR

Bill Boyce Decorators

A family run business with over 30 years experience

- Painting & Decorating
- Internal / External
- Offices, Restaurants & Private Houses
- Reliable
- Excellent Reputation
- All work carried out to a high standard
- Free Estimates



Call Bill on 07976 810680 or Dan on 07966 275134

89 Union Road, Shirley, Solihull, B90 3BY
 Tel: 0121 744 0040 or fax: 0121 744 0312
 Email: billboycedecorators@hotmail.co.uk
www.billboycedecorators.com

C. STEVENS ROOFING

EST FAMILY BUSINESS

NEW TILED ROOFS • GUTTERS
 FLAT ROOFS • BRICK WORK
 LEADWORK • SMALL REPAIRS
 UPVC FASCIAS • CHIMNEYS



KNOWLE

SOLIHULL

01564 790008 0121 733 1276

WWW.CSTEVENSTEROOFING.CO.UK

The Glorious Madness of The Beaujolais Run

At one minute past midnight on the third Sunday in November, villages and towns in a region in France release cases of wine for immediate delivery across the world.

"Le Beaujolais est arrivé!" This rousing call signals the introduction of the year's new wine, the famous Beaujolais Nouveau. Originally, pitchers of the wine were taken straight from the producers' barrels to the towns amid much fanfare and celebration. Then in 1972 an enterprising soul saw a fabulous marketing opportunity: a race to distribute the first bottles of the new vintage. The Beaujolais Run involves teams competing to be the first to get the first case of Nouveau from Paris to London. It's a 500mile race to south-eastern France to collect the first bottles of the new wine, and then 500 miles back again. Beaujolais is described by wine sellers as '...a light fruity red burgundy wine made from the Gamay grape.' It's described by almost everyone else as 'awful', and by French standards it's pretty rubbish if we're honest, so you'd have to be utterly bonkers to undertake a round trip of 1000 miles to get your hands on a bottle. Well, us Brits have elevated being bonkers to an artform. The more ridiculous or pointless the challenge, the more likely we are to bounce enthusiastically into action. And so it proved with the Beaujolais Run.

In its early years the event was purely about speed. Any mode of transport could be used. The glorious madness peaked in the 1980s when the RAF touched down in Beaujeu with a Harrier Jump-Jet at midnight, picked up the wine and then landed 32 minutes later in London. At that point the organisers had to rethink the rules! So now the mission is to get from southern England to Mâcon by covering the shortest distance. The Beaujolais Run has become a treasure hunt through the French countryside,

following a series of cryptic navigational clues through six checkpoints. Competitors must take a photograph of themselves at an obscure landmark at each checkpoint to prove they were there. You can use maps, sat-navs or even ask the locals! Handy Hint: Map readers tend to succeed over tech-users because some countryside back routes thwart the sat-navs.

The Beaujolais Run is a popular event in the amateur motor sport year, and anything goes - vintage cars family saloons, motorcycles

and even supercars. Dress code is fancy dress! There is a new theme every year and locals have learned to be quite blasé about being stopped and asked for directions by someone dressed as a gorilla, or a WWII German Officer, driving a Morris Minor! The entry fee is £1995 per car which includes the Eurotunnel fees, accommodation, and organised dinners and drinks events along the way. In addition, participants are required to raise a minimum of £1,250 per car for the Royal Air Force Benevolent Fund.

If you fancy taking part, take a look at www.beaujolaisrun.com for further information. You need a minimum of two team members, a vehicle, an entry fee, and the intention to raise a lot of money via sponsorship. A sense of humour and a love of scavenger hunts, cryptic clues and / or escape rooms is advantageous.

The French say, 'La vie est trop courte pour boire du mauvais vin', which translates as Life is too short to drink poor wine, however it would appear that Brits will happily drive very long distances for it!



Lady Katherine Housing & Care



Rated by the Care Quality Commission as:

GOOD

RESIDENTIAL CARE SHELTERED HOUSING RESPIRE CARE

(now taking Autumn and Winter Respite bookings)

*If you would like to pay us a visit or discuss our current availability
contact:*

Chris Mundell

on

01564 772415/ 07593 552136



How Much Is That Phone in the Advert?

Mobile phones are expensive. I mean really expensive. The latest iPhones and top of the range Android phones cost upwards of £1000 so they are a big financial commitment. But are they value for money? Is £1000 phone any better than one which costs £200?

When you watch a phone advert it's easy to believe that owning the latest model will make your life infinitely better. With ultrahigh resolution screens, multiple professional quality cameras and massively powerful computing engines, you could easily use your phone to replace your laptop, camera, TV and, at a push, your spouse!

But how many of these fantastic features will you actually use?

Most of use our phones for fairly mundane, low-power tasks. We text, check our social media, post selfies or snapshots, watch

YouTube videos, make quick videos to post on social media, play a game, and some of us even use them to make phone calls. But none of these tasks require any of the high-end features that are pushing the cost of your phone through the roof.

Budget phones summon up the image of a piece of sad plastic that struggles to turn on, let alone do anything useful. But there's a big difference between 'budget' and 'great value for money.'

Big brand names such as Apple and Samsung market their phones as status symbols. Pulling out the latest iPhone or flipping open your foldable Samsung is

the same as wearing a Rolex watch or rocking up in your sports car. If you enjoy that feeling and are happy with the cost then these are the phones for you.

If you want a phone that has almost all the features of the top brands; screen, cameras, powerful processor etc., there are a range of less well-known brands that will deliver all this for a lower cost. Many of these from Chinese manufacturers where components and labour costs are lower. You'll still get a high-quality product, and the phone will power through all of your day-to-day tasks with room to spare, but people won't recognise the logo on the back.



For example, my 12-year-old needed a new phone and we wanted to get one that would be fun to use rather than the low powered basic model he'd started out with. I came across a phone from Xiaomi, the Redmi Note 9. This has a

powerful octa core processor, loads of memory, 64 GB of storage space, ultrahigh resolution screen, three high resolution specialist cameras, fast charge, and long battery life and all for the very pocket friendly cost of £150. From a pre-teenage point of view, he's pleased as punch with the power and quality of the phone. From a parent point of view, I'm delighted with the price.

So, when buying a new phone my advice is to be honest about what you're going to use it for. If you feel a premium phone is worth the money go for it. If you want a phone that does everything and is a pleasure to use but is easy on your pocket, shop around.

ARE YOUR WINDOWS READY FOR A MAKEOVER?

New glass in your existing windows

- Replace failed double glazing; just the pane, not the frame

- Fix faulty hinges, handles and locks

A local family-run business with 10+ years of experience



Call **0800 048 5223** for a FREE Quote

Or visit **ClearlyBetterWindows.co.uk** to find out more

PSYCHOLOGICAL THERAPY. PRIVATE HEALTH CARE.

Equanimity CBT provides Cognitive Behavioural Therapy (CBT) which is the therapy of choice in the NHS for common emotional, behavioural and mental health problems. It is also available privately and through health insurance. Corporate referrals are also accepted.

Work related stress? Anxiety? Depression? Low self esteem? Compulsive behaviours? OCD? Anger management? Emotion regulation difficulties? Adolescent behavioural problems? Aggressive driving? Panic attacks? Phobias? Emotional distress?

Equanimity CBT

New Street, Kenilworth.
Wassell Grove Lane, Hagley.
Day and Evening Appointments Available

Contact: enquiries@equanimitycbt.co.uk
Telephone 0844 693 1282 for a
free 15 minute telephone consultation.

B.A.B.C.P. Accredited CBT Psychotherapist.



Approved Health Care Provider for
AXA-PPP, Aviva, BUPA, Allianz, CIGNA, Simply Health and WPA.

www.equanimitycbt.co.uk

Athos

solutions for the future...

BUSINESS SOLUTIONS

Chartered Certified Accountants

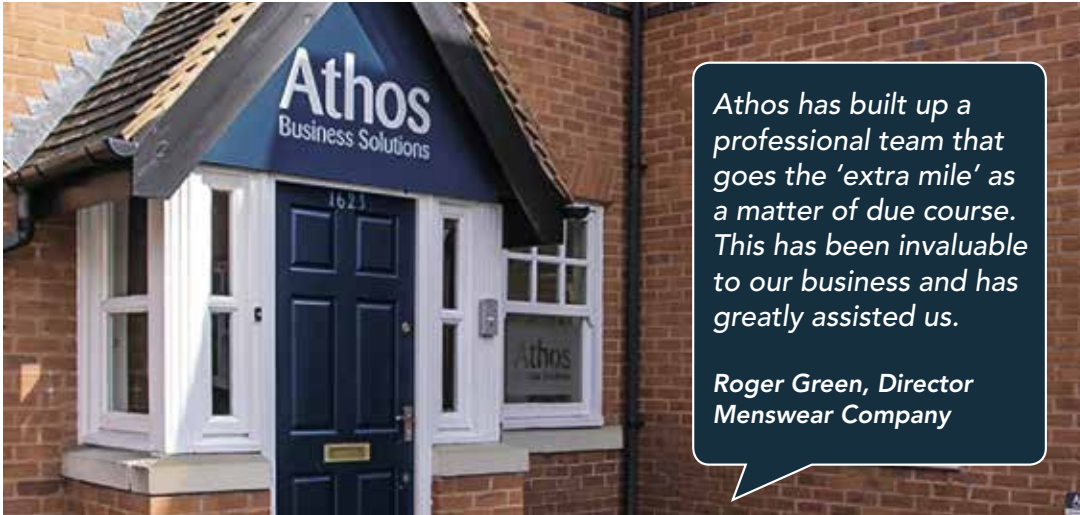

Athos has built up a professional team that goes the 'extra mile' as a matter of due course. This has been invaluable to our business and has greatly assisted us.

**Roger Green, Director
Menswear Company**

- Accounts
- Tax Returns
- Payroll and Auto Enrolment
- Bookkeeping and VAT Returns
- Tax Advice
- Management Accounts



Call and make an appointment for a free initial consultation where a bespoke fixed fee quotation will be provided.

T. 0333 400 7876

Athos Business Solutions Limited

1623 Warwick Road, Knowle, Solihull, West Midlands B93 9LF

www.athos.uk.com

enquiries@athos.uk.com



TAILORED HOME INSURANCE RIGHT DOWN TO THE FINEST DETAIL

Are you 100% happy with your current home insurance? Does the level of personal service you receive meet your expectations?

Because if not, you might like to consider NFU Mutual.

From our offices in Henley-in-Arden and Stoneleigh, we're uniquely placed to have a real conversation about your requirements.



So, for a truly personal approach to insuring your high-value property and contents, including valuables, fine art and collections, call Ross Chatterton at NFU Mutual Central Warwickshire on 01789 333228 or email Ross_Chatterton@nfumutual.co.uk



a good read

reviews By Willow Coby

Project Hail Mary

by Andy Weir

Ryland Grace wakes up on a spacecraft with no idea how or why he is there-or even who he is, and on top of this he has to work scientific miracles, from scratch using a Heath Robinson approach to staying alive. If this sounds like the plot of *The Martian* there are indeed similarities. Grace, like Mark Whitney is a scientist's scientist, self-deprecating, highly intelligent, and funny. The book alternates between Grace-on-Earth and Grace -in-Space as the narrative flips between the present day on the Hail Mary, and the events that led to him waking up alone and with no memory at the beginning of the book. The best science fiction happens when the author has put in the background work, uses it to craft a world we believe in, then creates characters we care about. Andy Weir has achieved all that here, and maintains a slick, fast paced plot to boot. There's loads of real science for the geeks, interesting, well-developed characters, excitement, thrills, and a touching friendship between the central characters. During the final third of the book, the stakes are raised ever higher, and I found myself reading ever faster in suspense all the way to the final page.



Everyone Dies Famous in a Small Town

by Bonnie-Sue Hitchcock

This is a young adult novel with a difference. It's a collection of interconnected short stories all set in the mid-1990s, in Alaska and small towns scattered across the American west. Each story centres around one or two disparate teen characters who each face the challenges and rewards of small-town life. Told through the ordinary events of their lives, we glimpse brief moments, like peeking through a window. We can see their inner struggles, how they deal with pain or boredom or survival, and how they find new paths and moments of healing. There are hitchhikers, kids with a 'reputation', free spirits, and young people who have suffered loss. Woven through the stories are some common threads; we get an early warning of wildfire in one story which is at the centre of the plot of another. The aftermath of events in one story, pop up in later ones. Each character's life has a 'butterfly effect' on the lives of other characters, some big and some small, and most of the characters never know the threads that connect them, even though we as readers are treated to the bigger picture and have the pleasure of seeing where all these lives overlap. In *Everyone Dies Famous in a Small Town*, Hitchcock takes us into the inner workings of young minds and hearts. A beautiful read for older teens.





Why not invest in a new driveway or patio to enhance the appearance and add value to your property?

Approved Drives and Landscapes offer a range of services to help improve all areas of your home, including:

Clay & Block Paving - Tarmacing (red or black) -
Patios - Brickwork - Slabbing - Gravel -
Landscaping - Fencing - Property Repairs
Roofing Repairs - Driveway Maintenance
(Pressure cleaning & sealing - weed free)

Proud member of



Find us in/on

Google



www.centraldrivewayslimited.com

Get in touch today for a FREE quotation

T: 0121 702 1456 M: 07748 577687

Michael.central@icloud.com



COMPETITION



Win 2 tickets

to see

GO NOW! The Music of The Moody Blues

at Solihull's Core Theatre on **Saturday 29 January 2022**

For your chance to win these tickets, visit the **Core Theatre website page for this event - www.thecoretheatresolihull.co.uk - to find the answer to this question:**

Who are joining Mick and Gordy on stage?

Email your answer to:

thecoretheatre@solihull.gov.uk -

and please put **'Moody Blues'** as the subject line.

Closing date for entries is 15th December.

The winner will be drawn at random and notified by email after this date.

Please note there is no cash value nor exchange for this prize so please don't enter if you cannot attend the date shown above.

About the show:

GO NOW! The Music of The Moody Blues is an opportunity for fans to experience this timeless music live, in a tribute to... The Greatest Classic Rock Band of a Generation and Rock and Roll Hall Of Famers THE MOODY BLUES.

Gordy Marshall toured and recorded with The Moody Blues for twenty-five years.

Together with Mick Wilson (lead singer of 10CC for twenty years) they present a super-group of world class musicians, singers and songwriters and meticulously recreate the elegance of a Moody Blues Concert.

In this show, all the classic hits are celebrated, including Nights in White Satin and a show-stealing rendition of Eve of the War from Jeff Wayne's The War of the Worlds.

Dorridge & Knowle Domestic Cleaning Services

- Small established cleaning and domestic help business
- Provide dedicated, friendly & trustworthy local ladies (*CRB checked*)
- Take pride in high standards and caring for customers' homes
- Regular service or one off spring cleans
- Ironing service available
- References available
- Comprehensive insurance
- Costs are not subject to VAT



For a FREE, no obligation quote,
please call Sue on 07809 567264

**Help make a world of difference...
Become a CAREGiver today!**

Home Instead Solihull

01564 330 395 | 01212 704 615

www.homeinstead.co.uk/solihull

Each Home Instead® franchise office is independently owned and operated. Copyright © Home Instead 2017.





**STU'S LOFT
LADDERS**

FREE

No Obligation Quote
10 year Manufacturer Warranty

Installing Loft Ladders Since 2008

All types of loft ladders professionally installed.

Top quality 3 section aluminium loft ladder professionally fitted with pivot arm, hand rail, wide flat treads for comfort and rubber feet. Loft hatch included.

ZARGES

YOUNGMAN
ALUMINIUM LADDERS AT BIRMINGHAM

ABRU

manthorpe
building products

We also install loft flooring and boarding

Areas that we cover?

- Redditch • Solihull • Stratford-Upon-Avon
- Worcester • Warwick • Birmingham • Evesham

Tel: 01527 850295 • Mobile: 07712 327889
stuart@stusloftladders.co.uk • www.stusloftladders.co.uk



CROSSROADS SERVICE STATION LTD

A friendly, family-run business since 1969

- MOT Testing – Cars & Motorbikes
- Servicing & Repairs
- Air Conditioning Service & Repair
- Diagnostic Service & Repair
- Laser Wheel Alignment
- Tyres – Supplied & Fitted
- Qualified & Experienced Staff
- Courtesy Car or Collection/Delivery available

**OPEN 6 DAYS
A WEEK**

MON – FRI 8.00am – 6.00pm
SAT 8.00am – 1.00pm

COVID SECURE

VOSA RMI

599-601 Tanworth Lane, Shirley, Solihull B90 4JE

Tel: 01564 703225

www.crossroadservicestation.co.uk

VAT No.: 113213041

Hear This - Tinnitus is a modern epidemic

Tinnitus is the name given to the perception of persistent ringing, buzzing, hissing, or whistling sounds in the head or the ears without an external sound source. The word 'tinnitus' derives from the Latin for 'ringing'. It can be intermittent or continuous; low, medium, or high pitched and can be a single noise or many. It can be heard in one or both ears, or may feel like it is in the head. For some people it's a minor annoyance, but for others it can be debilitating.

It is not a disease or illness; it is a symptom generated within the auditory system which may be due to an underlying condition or may be idiopathic (a medical term which means 'unknown cause').

The British Tinnitus Association estimate that 1 in 8 people suffer from the condition. Tinnitus in older people is mostly a function of wear

and tear, so as people live longer, the number of people with tinnitus will increase. But the rise in numbers over the past two decades is only partially explained this way. A study from Statistics Canada revealed that 80% of adults aged 19 to 29 reported using headphones or earbuds connected to audio devices in the past year, significantly more than adults aged 30 to 49 (53%) or 50 to 79 (28%), and those adults aged 19 to 29 had rates of tinnitus over one third higher than for older adults. This could further inflate the numbers.

If your tinnitus is preventing you getting to sleep, it may be that the shift from a relatively noisy daytime environment to the quietness of the bedroom makes the tinnitus noises more noticeable. Some people find having some low-level sound can help mask tinnitus.

For more information go to www.tinnitus.org.uk



No call-out charge
Available 24/7

JUST
MOVED IN?
CALL US
FOR NEW
HOME
PACKAGES

CALL TODAY FOR A FREE, NO-OBLIGATION SECURITY CHECK AND ADVICE

Locked Out

We can gain access for you non-destructively

Emergency Locksmiths

15-30 min emergency response time for your peace of mind

uPVC Door Lock Specialists

Our locksmiths are specialists in uPVC door and window locks

Door/Window Handles Changed & Replaced

Stuck, broken or damaged window handles? We can help

Lost Keys

Lost your keys? We recommend a full lock change service for your security

Locks Changed & Replaced

Lock replacement and upgrades, all with a 12 month guarantee

Home Security

We offer a variety of smart camera and alarm systems to protect your property

Emergency Boarding Up & Burglary Repairs

We can offer a 24/7 emergency boarding up and repair service



**12 month parts
& labour guarantee**



lewis@lockfit.co.uk
www.lockfit.co.uk/lockfit-locksmiths-knowle/

01564 627 020

Poached Pears

Pears are in season right now and this is such a great way to serve them



Preparation time: 15 minutes

Cooking time: 1 hour + 5-10 minutes for the sauce

Serves: 4

Ingredients

1 750ml bottle of soft, fruity red wine
125g granulated sugar
2 cloves
1 stick of cinnamon
Zest of half a lemon
1 vanilla pod, split (optional)
4 hard pears
Creme de cassis

Method

Preheat the oven to 180C/ gas mark 4. Pour the wine into a saucepan with the

sugar, spices and lemon zest and bring to the boil, stirring dissolve the sugar.

Meanwhile, peel the pears. Leave the stalk intact but cut out the core at the base. Use a non-metallic ovenproof dish just wide enough to hold the pears in a single layer and lay them in there. Don't use a large dish because when you pour the spiced wine over the top - the fruit should just be submerged. Cover the dish

and bake for about an hour, checking after 45 minutes. When the fruit is tender, but still holds its shape, lift it out of the liquid and set aside.

Then pour the liquid back into the saucepan and bring to the boil. Reduce by about half until it becomes thick and syrupy, then taste and pour in the creme de cassis to taste. Pour the sauce back on to the pears and serve warm or cool, with ice cream, cream, or custard.

Do you want to grow your business?

If you want to meet more prospects, gain referrals, and network with other local businesses, then join the Knowle & Dorridge BOB Club.

We meet for an hour every 2 weeks (online currently) to exchange information, swap ideas, and help each other generate more business.

There's no pressure to give referrals or provide substitutes if you can't make a meeting, it's friendly and informal, and incredibly supportive.

Join our next meeting for free. To try BOB for yourself, and meet other like-minded local businesses visit:

www.bobclubs.com/Club/Knowle

Or contact

Patrick on 07490 645665

patrick@yourfinancefriend.co.uk



Join thousands of business owners around the world

at a local club that's part of one of the World's largest business networking organisations.



“Improving the way you get business”

5 Reasons Why You Should Visit Canada

1. Unforgettable Wildlife

The amazing diversity of wildlife in Canada is one of the top reasons as to why people travel to Canada. The country's most famous animals are thanks to a wide range of habitats, such as forests, sea and snow. During the summertime in British Columbia, a phenomenon known as the Salmon Run brings a high number of grizzly bears to places along the west coast.

2. The Great Outdoors

Scenic coastlines, sprawling prairies, picturesque forests and magnificent mountains make Canada home to some spectacular scenery. The range you'll find in Canada is incredible, across the territories and provinces you'll find icefields and mountains in some and world-class beaches and coastlines in others. Natural parks can be found all across the country, providing some incredible backdrops for your morning hike. You'll find plenty of natural wonders located in Canada such as the awe-inspiring Rocky Mountains and the famous Niagara Falls.

3. Rich Culture

In Canada, the people, culture

and communities encapsulate the past of the country and you'll find this no matter what part of the country you're visiting. There is an incredible rich indigenous culture that can be found across the country and you can enjoy First Nations art in the likes of British Columbia. The First Nations people are the largest group of aboriginal peoples in Canada, with more than 600 recognised bands across the country.

Canada is also home to the Inuit who mainly live in the Arctic areas, while the Metis people are a distinct group that came from the multicultural interactions of the Europeans and First Nations people.

4. The Rocky Mountaineer

You might have seen this iconic railway on TV series, the Rocky Mountaineer train journey not only gives you unrivalled views of the Rocky Mountains from its glass-domed roof, but the incredible hosts make sure you're comfortable and tell you fascinating stories about the places you travel past.

5. The Skiing

If you're looking for some of the best powder in the world,



Canada is your place. You'll find some world-class ski resorts such as Whistler, Sun Peaks, Big 3 in Banff and Tremblant to name a few. Plus all resorts have a great choice of runs perfect for beginners to pros. If skiing or boarding isn't quite your thing, you won't be left out. There are awesome winter sports such as tubing, snowshoeing and sledging or if you're wanting a more laid-back vibe hit up one of the Scandinavian-style spas.

Sabina Clay

Not Just Travel
sabina.clay@notjusttravel.com
07565 534 524





N NOT JUST TRAVEL

HOLIDAYS
MADE Better

Choice • Service • Value

ENQUIRE NOW

Any trip • Anywhere • Anytime • Tailor-made

Honeymoons - Cruises - Adventure Packages - Flights
Hotels - Extras - Airport Car Parks - Weddings Abroad



Sabina Clay
Not Just Travel
sabina.clay@notjusttravel.com
07565 534 524



DMC PLUMBING

For all your plumbing requirements
from small leaks to full
bathroom refurbishments.

- All work guaranteed
- 24 hour emergency call out
- Established over 25 years.

Contact Dave on:

07792 296728
01564 772 876



TO ADVERTISE HERE

Advertise

Contact Zoe Reece on 07557 220585 /
zoe@dorridgedirectory.com

Protect and Survive

Not the 1970s public information campaign exhorting us to hide under a table in case of nuclear attack. This is far more useful. It's my public information campaign

about protecting tender perennials and taking cuttings to over winter so your plants survive and even multiply. First the protection: to protect tender perennials such as Salvias and Pelargoniums, lift them and bring them into a greenhouse. If you have a heater, set it to the frost setting (around 5C). You can use bubble wrap to insulate the greenhouse for additional heat conservation. If you do this the heater will only need to kick in on extremely cold days and nights.

For tender bulbs and tubers such as dahlias, wait until the foliage has been blackened by the frost, then lift them and place in a box of sand in a dry, dark, frost-free location.

Plants like Agapanthus, which are generally happy to be left in the ground with a little protection, are best left undisturbed. Cover the top with a generous quantity of well-rotted compost or bark mulch. This can be removed from around the crown of the plant in spring and will help retain moisture throughout the spring growing season.

November is the start of the bare root planting season. Plant roses, hedging and trees, and it's also a good time to move any of these plants which you think are in the wrong area of the garden. They are more likely to survive this treatment if moved at this time of year.

So, what else can we do in November?

- Ideally your spring bulbs should already be planted but if you haven't done it yet, just put some in this month. November is actually the perfect month to plant tulip bulbs are because the less time they are in the ground the less likelihood of them developing a virus called tulip fire blight.
- Plant garlic cloves if you have an area with free draining soil.
- Dig over the vegetable plot, leaving clods to break down over winter
- Rake the fallen leaves regularly from lawn areas because if you leave them they deprive the lawn of light.
- Bring in garden tools for the winter. Clean, sharpen, and oil them first.
- Keep removing weeds. It is easier to see them once garden plants have died back. November is a great time to get rid of persistent perennial weeds





EASTCOTE
PARK
CINNAMON LUXURY CARE

RETIREMENT
APARTMENT
WINTER
INCENTIVE

CALL TO FIND
OUT MORE



THE PERFECT PLACE FOR WINTER SECURITY

At Eastcote Park Retirement Village & Care Home we offer companionship and security giving you peace of mind in a warm a friendly environment.

The exceptional Eastcote Park retirement apartments provides the opportunity to live independently and enjoy extensive state-of-the-art facilities whilst our care home provides exemplary care and support in luxurious yet homely surroundings.

At Eastcote Park, people will always come first.

For more information or to book your personalised tour please call our Team on 01564 757237 or email eastcote.enquiries@cinnamoncc.com

RETIREMENT APARTMENTS | RESIDENTIAL CARE | DEMENTIA CARE | RESPITE CARE

Eastcote Park Retirement Village & Care Home Knowle Road, Eastcote, Solihull B92 0JA

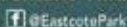

@EastcotePark

www.cinnamoncc.com/eastcote

To view other Cinnamon Care Homes in the West Midlands visit cinnamoncc.com/westmidlands

crossword

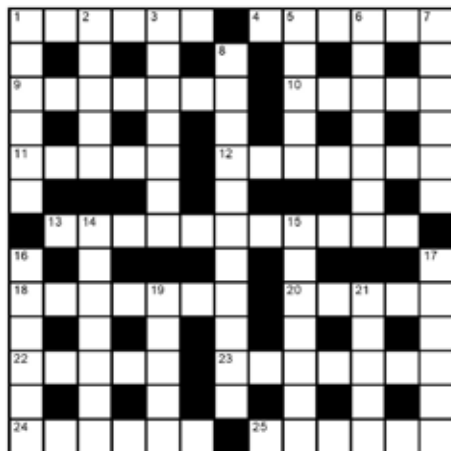

clues

- 1 Second in command (6)
- 4 Person who maltreats or harms (6)
- 9 Flammable gas (7)
- 10 Small herring (5)
- 11 British Actress _____ Mirren (5)
- 12 American term for poorly educated person from the south (7)
- 13 Weaken, fall apart (11)
- 18 Delinquent, thug (7)
- 20 Man-made fibre (5)
- 22 Home of Glasgow Rangers (5)
- 23 _____ Man - Beatles song (7)
- 24 There are eleven in the song 'Twelve Days of Christmas' (6)
- 25 Large snake (6)

Down

- 1 Hidden _____ - quiet wisdom or insight (6)
- 2 Move stealthily (5)
- 3 Learner, cadet (7)
- 5 Located, stationed (5)

Across

- 6 Glut, plethora (7)
- 7 Second try at an exam (6)
- 8 The action of enlisting new people (11)
- 14 Activity done purely to increase someone's sense of self-importance (3,4)

Across

- 15 Escapee, fugitive (7)
- 16 Shellfish (6)
- 17 Hidden, not noticed (6)
- 19 Famous Egyptian city (5)
- 21 Blood-sucking worm (5)

answer on page 45

how to play sudoku

It's simple!

Fill in the grid so that each row, column and 3x3 box, contains the numbers 1 through to 9 with no repetition. You don't need to be a genius. These puzzles use logic alone. Watch out! Sudoku is highly addictive.

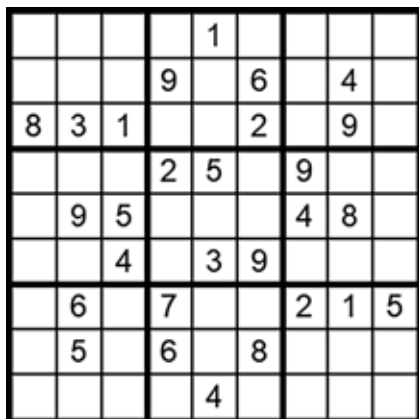

answer on page 45

WESTBRIDGE ROOFING & BUILDING

LET'S TAKE YOUR HOME TO THE NEXT LEVEL



Our family has been in the building and roofing trade for over 50 years gaining trust and experience along the way.

All services are tailored to your needs, and we can't wait to help you transform your home!



FREEPHONE:

0800 037 0122

Unit 35, 64 Marshall Lake Road, Solihull B90 4PL

Website: www.west-bridge.co.uk | Email: westbridge1@hotmail.co.uk

A collection of business-related icons. In the center is a silver laptop with a green screen. To its left are several white documents; one features a green and grey circular chart, another has a green dashed line graph, and others show tables and signatures. Above the laptop is a large green and grey circular chart. To the right of the laptop are two interlocking grey gears and a small green and grey circular chart. Below the laptop are a pair of black-rimmed glasses, a small green and grey circular chart, and a document with a green bar chart. In the bottom right corner is a small white card with a green bar chart.

Bespoke content managed websites, SEO, social media management, print management, logo design, clothing, copy writing and much more.

0121 369 1977

www.hotlobster.uk.com

BRING YOUR PARTY TO OUR PARTY!

Enjoy Party Nights

in **Rick's** & **THE MARQUEE**
at Nailcote Hall Hotel



NOVEMBER 2021

Sat 13th	THE FREDDIE MERCURY SHOW with BRUCE GAME	£40.00
Sat 20th	'STAR NIGHT' RAY QUINN – SWING CLASSICS & CHART HITS SHOW	£49.50
Sat 27th	THE SNOWBALL CHARITY 'BLACK TIE' PARTY with BORN IN THE 80's	£49.50

DECEMBER 2021

Fri 3rd	THE No.1 TRIBUTE TO WHITNEY HOUSTON with NYA KING	£44.50
Sat 4th	CHRISTMAS MOTOWN DIVAS SHOW with THE DREAMETTES	£44.50
Sat 4th	'PARTY ANIMALS' CHRISTMAS PARTY with RANG-A-TANG	£49.50
Fri 10th	GEORGE MICHAEL TRIBUTE SHOW with MICHAEL GEORGE	£44.50
Fri 10th	SOUL & MOTOWN PARTY with SOULTOWN COLLECTIVE	£49.50
Sat 11th	BACK TO THE 60's PARTY with THE REVOLVERS	£44.50
Sat 11th	'MAMMA MIA' PARTY with BOOTLEG ABBA	£49.50
Sun 12th	FESTIVE AFTERNOON TEA with NOSTALGIC SONGS BY STACEY LYNN	£29.50
Wed 15th	THE No.1 ROD STEWART TRIBUTE with GARRY PEASE	£39.50
Thu 16th	SOUL AND MOTOWN PARTY with COLIN 'SUGARFOOT' MILLS	£39.50
Fri 17th	THE ULTIMATE 90'S PARTY with NOUGHTY 90's	£44.50
Fri 17th	THE 'TAKE THAT' SPECTACULAR with TAKE@THAT	£49.50
Sat 18th	CHRISTMAS MOTOWN DIVAS SHOW with THE DREAMETTES	£44.50
Sat 18th	THE ULTIMATE 80's PARTY with ADDICTED TO 80's	£49.50
Fri 31st	NEW YEARS EVE 'BLACK TIE' BALL with RANG-A-TANG, SUZI WOODS & PIPER	£90.00

TICKET PRICES INCLUDE 3 COURSE MEAL - WE WILL CATER FOR ANY SPECIAL DIETARY NEEDS BY PRIOR ARRANGEMENT

PLEASE VISIT OUR WEBSITE TO SEE FULL DETAILS
nailcotehall.co.uk

BOOKING HOTLINE CALL: 02476 466174



Nailcote Hall
Hotel, Golf & Country Club

info@nailcotehall.co.uk
Nailcote Lane, Berkswell, Warwickshire CV7 7DE

useful numbers

Health

NHS non-emergency	111
Dorridge Surgery	01564 776262
Knowle Surgery	0121 796 2777
Solihull Hospital	0121 424 2000
Spire Parkway Hospital	0121 704 1451
Daleswood Health, Solihull	01675 489489

Council

Solihull Council	0121 704 6000
------------------	---------------

Utilities

Electricity power cut	0800 6783 105
Gas leak	0800 111 9999
Severn Trent Water	024 7771 5000
Severn Trent Water (emergencies)	0800 783 4444

Travel

National Rail Enquiries	03457 48 49 50
Network West Midlands (buses)	0345 303 6760

LOCAL COUNCILLORS

DORRIDGE & HOCKLEY HEATH

Ian Courts

Tel: 01676 535490
icourts@solihull.gov.uk

Andrew Mackiewicz

Tel: 01564 230294
amackiewicz@solihull.gov.uk

Ken Meeson

Tel: 01564 777772
kmeeson@solihull.gov.uk

KNOWLE

Diana Holl-Allen MBE

Tel: 01675 443112
dhallen@solihull.gov.uk

Jeff Potts

Tel: 01564 774804
jpotts@solihull.gov.uk

Alan Rebeiro

Tel: 01564 200047
arebeiro@solihull.gov.uk

local police contact for knowle & dorridge

Sergeant Mike Lloyd

Telephone: 101 ext 892 6037

Email: rural@west-midlands.pnn.police.uk



Accountants

26 Athos Business Solutions 0333 400 7876

Bathrooms and Kitchens

11 Cullen Plumbing & Tiling 07896 862916

Blinds and Curtains

7 Hillarys 07738 990211

Builders41 Westbridge Roofing
& Building 0800 037 0122**Builders' Merchants**

47 EH Smith 0121 713 7100

Business Networking

35 Knowle BOB Club 07490 645665

Car Services32 Crossroads Service
Station 01564 703225**Care Services**

5 Avery Healthcare 01564 621393

15 Belmont @ Home
Care 0333 444 012123 Lady Katherine Housing
& Care 01564 772850

31 Home Instead 01564 330395

39 Eastcote Park 0121 269 1236

Carpets & Flooring

1 D.A. Mander & Son 01564 700200

19 Acorn Floors 0121 693 3301

Cleaning Services31 Dorridge & Knowle
Domestic Cleaning
Services 07809 567264**Doors and windows**

7 ACS Doors 07592 303104

18 Garolla garage doors 0121 369 0774

25 Clearly Better Windows 0800 048 5223

Estate agents

48 DM & Co 01564 777314

Events

43 Nailcote Hall 02476 466174

Gardens and drives

8 Oakland Group 01564 758608

10 Solihull Tree Care 0121 604 6809

17 Green Thumb 0121 705 6395

20 Dimension Landscape
& Driveways 0121 733 146329 Central Drives
Landscapes 0121 702 1456**Gift wrapping**

13 Banana Leaf 07842 759266

Graphic and Website Design42 Hot Lobster
Design Ltd 0121 369 1977**Health and wellbeing**

16 MUMS 0121 704 2669

25 Equanimity CBT 0844 693 1282

Heating9 Stephen Smith Plumbing
& Heating 01564 200119**Insurance**

27 NFU Mutual 01564 792215

Languages

18 Beech Languages 01564 739621

Locksmiths

33 Lockfit 01564 627020

Lofts

32 Stu's Loft Ladders 07712 327889

Painter & Decorator

21 Bill Boyce 0121 744 0040

Plumbing3 Knowle Domestic
Appliance Repairs 01564 7301839 Stephen Smith Plumbing
& Heating 01564 20011911 Cullen Plumbing
& Tiling 07896 862916

37 DMC Plumbing 07792 296728

Roofing

2 N. Bird & Son 0121 743 6324

9 React Roofing 07922 230477

21 C Stevens Roofing 0121 733 1276

41 Westbridge Roofing
& Building 0800 037 0122**Solicitors**14 Shakespeare
Martineau 0121 705 8151**Tiling**

11 Cullen Plumbing & Tiling 07896 862916

Travel Agent

37 Not Just Travel 07565 534524

9	4	6	3	1	5	7	2	8
5	7	2	9	8	6	1	4	3
8	3	1	4	7	2	5	9	6
6	8	7	2	5	4	9	3	1
3	9	5	1	6	7	4	8	2
2	1	4	8	3	9	6	5	7
4	6	8	7	9	3	2	1	5
1	5	9	6	2	8	3	7	4
7	2	3	5	4	1	8	6	9

Sudoku Solution

from page 40

D	E	P	U	T	Y	A	B	U	S	E	R
E	R	R	R	A	U	E					
P	R	O	P	A	N	E	S	P	R	A	T
T	W	I	C	E	F	A					
H	E	L	E	N	R	E	D	N	E	C	K
S		E	U		I	E					
S	G		T	U							
H	O	O	D	L	U	M	N	Y	L	O	N
R	T	U	E	A	E	S					
I	B	R	O	X	N	O	W	H	E	R	E
M	I	O	T	A	C	E					
P	I	P	E	R	S	P	Y	T	H	O	N

crossword Solution

from page 40

A Tiny Musical Renaissance

There's so much to love about the ukulele

In September while staying with friends in the countryside, I attended a late summer fete. It was a low budget cliché involving hay bale seats, a hog roast, young performers from the local school and a smattering of stalls selling jams and random craft items. It amused my friends to drag a cynical Londoner to an event which included the 'Most Creative Vegetable Sculpture' award.

They insisted I stayed to listen to the village ukulele 'orchestra', which comprised an enthusiastic group of players who took the stage wearing amusing hats, and wielding kazoos. They chink-a-chinked their way through hits from the sixties to the nineties with an occasional nod to timing and tuning. They were joyous in their performance, and clearly loved every minute of their local celebrity. During their twenty-minute set they embodied everything that music should be: accessible, enjoyable, and inclusive. The audience (and I) loved them, to the amusement of my friends.

Back at home I googled ukuleles. There are at least 300 groups in the UK and a number of ukulele festivals, which occur throughout the year. Local events in churches and school halls nearly always play host to a home-grown group of enthusiasts.

The ukulele arrived here from Hawaii over a century ago. Contrary to popular belief it was not born in Hawaii but originated in Europe and was originally known as a branguinha, or machete. It was introduced to Hawaii in 1879 by a Portuguese immigrant named Joao Fernandez. The Hawaiians were so impressed by his fingerboard gymnastics that they called the instrument "ukulele," (pronounced oo-ko-lay-lay) which translates to "jumping flea." Fernandez became a local sensation and the popularity of the little instrument spread across

the islands.

When it arrived in the UK it was initially considered an exotic instrument but was quickly snubbed by both the pop and classical music scenes; even folk groups didn't want a ukulele! But with the help of the hipsters (who play their ukes ironically) and armies of mainly senior citizens up and down the land (who play them sincerely and with gusto), and schools, where they've replaced the previously ubiquitous recorder as training instruments, the little ukulele has become the musical comeback kid. This can be traced in large part to its accessibility, affordability, and YouTube popularity. While festivals offer live workshops on fingerpicking, playing by ear, and even song writing, most people do seem to learn their uke skills from YouTube.

Well, dear reader I bought myself a uke and I have discovered the joy of learning an instrument in my fifties. There are no uke police, so unlike the music lessons of my early years, there are no disapproving teachers dripping sarcasm and heaving sighs. I am responsible for my own progress and even though I have not yet plucked up the courage to join my local uke orchestra, thanks to Professor YouTube I can bash out a few chords and simple tunes.

And that's the joy of the ukulele. Unlike the piano it doesn't demand virtuosity, and unlike the violin there's no painful induction period, even absolute beginners can make a pretty sound. This cheerful unintimidating little instrument is enjoying a well-deserved renaissance, so why not join the fun?



Now Open



Visit our new showroom today for new and innovative styles and trends to update your kitchen or bathroom.

Symphony®

ROT
PUNKT
KÜCHEN

LAURA ASHLEY
BATH COLLECTION

Utopia

MACKINTOSH®

NEFF

 **EH Smith**
**KITCHENS &
BATHROOMS**

 127 High Street,
Henley-in-Arden, B95 5AY

 0121 713 7270

 info@ehsmith.co.uk

WISHING TO

MOVE HOME IN

THE NEAR

FUTURE?

Perhaps now is the time to make
that decision?



CALL US WHEN YOU'RE READY ON

01564 777 314