

the knowle & dorridge directory

october 2021

a community magazine and business directory
for residents of knowle and dorridge

N.BIRD & SON

ROOFING SERVICES



FREE QUOTES

EST 1987 SOLIHULL BASED

- Small Repairs
- Flat Roofs
- New Roofs
- Ridge Tiles
- Chimney Work
- Lead Work
- UPVC Facia, Soffit & Gutters
- GRP Flat Roofs

0121 743 6324

LOCAL FAMILY RUN BUSINESS



249 Lyndon Road, Solihull B92 7QP

www.knowleanddorridgedirectory.com

delivered FREE to 5400 homes



Bastock & Bruce Ltd

F U N E R A L D I R E C T O R S

A partnership between C. Bastock Ltd and Bruce Bragg

Bruce is now the only remaining member of the Bragg family still in the funeral business following the sale of the Bragg family business in Shirley to a national group.

This partnership brings a family business to Knowle with generations of experience ensuring the truly personal service you would expect from an independent Funeral Directors.

Brisker Court, 1685, High Street,
Knowle, Solihull. B93 0LN

01564 33 5577 (24 hour)

Serving all surrounding areas

If Knowle is difficult to get to,
home visits can be arranged
or we can arrange to use any of the
Bastock family funeral homes in Olton,
Shirley or Yardley.



www.bastockandbruce.co.uk
info@bastockandbruce.co.uk

Knowle Domestic Plumbing Service & Appliance Repairs

All Plumbing Work Undertaken

- ***Burst pipes/leaks***
- ***Taps, Sinks, Waste Units***
- ***Ball Valves, Overflows***
- ***Tanks, Cylinders, Immersions***
- ***Toilets, baths, Showers***
- ***24 Hour Emergency***

Appliance Repair Services

- ***Washing Machines***
- ***Dishwashers***
- ***Tumble Dryers***
- ***Electric cookers***
- ***Vacuum Cleaners***

£10 OFF for first time customers with this ad.

Valid until: 10th November 2021

***12 month guarantee, same day call-out
special rates for OAP's***

Office: 01564 730183

Mobile: 07770 698196

Boo...

Welcome to the
October edition...

Hopefully kids will be able to celebrate Halloween and go trick and treating this year, and enjoy the fun of Bonfire Night after the disappointment of so many events being cancelled last year. Check out page 6 to find out more about 'pumpkin week' and other local events.

If you fancy winning a bottle of Prosecco, just scan the QR code below to be entered into our free prize draw.

All you need to do is submit a Google review of the magazine and we'll draw a winner at random and deliver a bottle to your door!*

Zoe

Zoe Reece

Tel: 07557 220585

Email: zoe@dorridgedirectory.com

www.knowleanddorridgedirectory.com

contents

- 6 Events
- 28 Book reviews
- 34 Recipe
- 40 Puzzles
- 44 Useful telephone numbers
- 45. Index



*** Google reviews** must be received by 10th November 2021. To qualify you will need to email zoe@dorridgedirectory.com after you have submitted a review with your name, telephone number, and address (which must be in the B90 or B91 postcode).

Locally designed by: hotlobster design ltd Printed by: Norwood Press

PLEASE RECYCLE THIS MAGAZINE

Considering moving home, re-mortgaging or investing in the property market?

GET IN TOUCH WITH SAMANTHA HEMS TODAY FOR A FREE INITIAL MORTGAGE CONSULTATION



Contact: 07531047301

Email: samantha@mortgagebrothers.co.uk

As a whole of market mortgage advisor, I have access to an extensive range of lenders across the UK. This allows me to gain the most cost effective mortgage product according to your needs and circumstances. I'm an advisor that won't use technical jargon and who keeps things simple but who is always professional, allowing you to understand the market place and have confidence in the mortgage product that is selected for you.

- ✓ FIRST TIME BUYERS
- ✓ HOMEMOVERS
- ✓ RE-MORTGAGES
- ✓ BUY TO LET
- ✓ DEBT CONSOLIDATION

MORTGAGE BROTHERS LTD IS AUTHORISED AND REGULATED BY THE FINANCIAL CONDUCT AUTHORITY
YOUR HOME IS AT RISK IF YOU DO NOT KEEP UP WITH YOUR MORTGAGE REPAYMENTS



community events

Pumpkin Week

Hatton Country World

21 – 29 October

Pick your own free pumpkin, carve it in the spooky decorated marquee and then enter the best carved pumpkin competition to win a prize. Experience the Mystifying Halloween Show, Haunted House, Laser Combat Game and Mega Maize Maze.. and lots more.

Happy Hour

Turtle Bay, Solihull

Enjoy 2-4-1 cocktails and mocktails as soft reggae beats and the magic of the Caribbean soothe your soul. Sunday to Thursday 10am - 7pm & 9.30pm – close. Friday & Saturday 10am - 7pm & 10pm – close.

Wythall & Hollywood Country Market

Wythall Park, Silver St, Wythall

30 October, 6 / 13 / 20

November 10am – 12 noon

Farmers' market and craft fair offering a wonderful array of home-produced goodies including jams, cakes, biscuits, bread, soups, stir-fries, seasonal vegetables, potted plants, gifts, and cards. Also available: craft demonstrations, kids' crafts, tea and coffee. Email whcountrymarket@gmail.com for more info.



Stories in Stitch Exhibition

Courtyard Gallery, Core

Theatre Solihull

10-22 November

This exhibition by Solihull Creative Textiles will feature a group collaboration entitled The Seasons, as well as individual pieces based on the theme of Stories in Stitch. Samples of work from workshops will be on display and there will be a selection of handmade stitched items for sale. www.facebook.com/solihullcreativetextiles

Alice in Wonderland

The Old Rep Theatre, Birmingham

20 November – 17 December

This adaptation of Lewis Carroll's classic tale follows the story of

Alice, a young, curious girl who follows a white rabbit down a rabbit hole and into Wonderland. There, she encounters some of the strangest and most peculiar creatures, including the Cheshire Cat and the Mad Hatter. With songs old and new, and a brand-new script this is set to be a spectacular experience.

A Christmas Fair

Knowle Village Hall

Saturday 27 November

10sm – 1pm

Browse through Christmas cards, gifts, cakes and preserves, decorations, books, bric-a-brac and more. There will be competitions and refreshments. This is a Knowle Village Hall fundraising event.



Beautiful Interior Doors Supplied and Installed



www.acsinteriordoors.co.uk

Come and visit our NEW showroom in Studley

Unit 1,
Haydon House,
Alcester Road,
Studley
B80 7AN

07592 303104 or
07910 289565

YOUR LOCAL BLINDS, CURTAINS & SHUTTERS SPECIALIST

✓ Friendly local service ✓ Options for every budget ✓ Price includes measuring & fitting



- I provide expert advice on the best window solutions
- Flexible appointment times
- Over 1000 fabrics & styles to choose from
- Blinds & curtains made right here in the UK
- Ask me about multi-blind discounts
- I won't be beaten on price*

ROLLERS | ROMANS | VERTICALS | VENETIANS | CURTAINS | SHUTTERS | WOODEN BLINDS

Call me for a free in-home appointment:

Chris Gaite 07738990211

*Based on the same spec, size & levels of service.

HILLARYS
Solihull

OAKLAND



GROUP

Service Quality Value

Professional Outdoor Services



Tree Surgery & Hedging



Landscaping

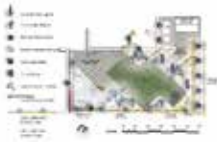

Garden/Lighting
Design



Porcelain Garden



Fencing



Planting &
Irrigation



Outdoor Lighting



Borders &
Maintenance



Visit us at Rosebourne Garden Centre
Kenilworth Rd, Hampton in Arden,
Solihull, B92 0LP

01564 758 608

www.oaklandgroupuk.com

www.12vgardenlights.com

info@oaklandgroupuk.com



Stephen Smith & Son Plumbing & Heating Services



Accredited
Installer



Gas Safe reg no: 198187
Natural Gas, LPG & Oil



**Tel: 0121 247 4957
or 01564 200119**

**10 years Manufacturer's Warranty
on all Worcester Greenstar
gas boilers installed***

www.stephensmithandson.co.uk

"Family business. Local and reliable."

Work carried out includes:

- Boilers / Radiators
- Natural Gas - LPG and Oil Installation and Repair
- Landlord Gas Safety Inspections/Certificates
- Boiler Servicing
- Hot Water Cylinders (vented and unvented)
- System Powerflushing
- Cold Water Tanks
- Shower Installations / Repairs
- Pipework
- Underfloor Heating

*Worcester Bosch terms apply



For your **FREE** quotation please contact
React Roofing today!

- NEW ROOF SPECIALISTS
- FASCIAS, SOFFITS & GUTTERING
- FLAT ROOF SPECIALISTS
- GRP FIBRE GLASS ROOFING
- LEAD WORK
- CHIMNEY REPAIRS & BUILDS



Tel: 07922 230 477

Email: reactroofingservices@gmail.com

www.reactroofingservices.co.uk
Based in Solihull

**All aspects of arboriculture
work undertaken.**

**Pruning, thinning, reshaping,
crown lift, reductions,
removals and stump removal.**

- All hedge work
- All waste removed
- All work guaranteed to the highest industry standards
- Fully insured
- Free advice and quotations
- NTPC Qualified Workforce



COVID-19 UPDATE:

We are still working – safely and in line with Government guidelines regarding social distancing

Freephone: 03335 775733

Mobile: 07786 527 729

Email: info@solihulltreecare.com www.solihulltreecare.com

Cullen

Plumbing & Tiling

17 Whitacre Rd, Knowle
cullenplumbingandtiling@gmail.com

Tel: 07896 862 916

Established in 2005

City & Guilds

Qualified

- Full bathroom and ensuite design and installation to the highest standards with complete project management from start to completion
- Kitchen Sinks and Taps, Dishwasher and Washing Machine Installation
- Central Heating & Radiators
- General Plumbing Maintenance & Repair
- Showroom Finish Wall & Floor Tiling for bathrooms, kitchens, hallways and conservatories
- Specialist in ceramic, porcelain, natural stone tiling
- Business built on recommendation and reputation

All Work Guaranteed

Reliable Honest Service

References and Portfolio of Work Available



Call Alex Cullen

NOW on 07896 862 916

For a free no-obligation quotation

Why We Love Ghosts

Recent studies show that between 30-40% of people in the UK are believe in ghosts, with those aged between 18 and 34 most likely to believe in paranormal activity. In the US figures are much higher.

Unlikely as it seems, ghosts and hauntings are a mainstream area of belief, and this belief is global, with most cultures around the world having some widely accepted types of ghosts. But why are people so keen to believe when the existence of a ghost as a disembodied soul or spirit of a dead person directly contradicts the laws of science?

In literature ghosts address some basic human needs, including the desire for justice. Shakespeare's Hamlet is visited by the ghost of his murdered father seeking revenge on Claudius, his murderer; and in Macbeth the murdered Banquo appears at a banquet both as a reminder of Macbeth's guilt and to foreshadow more deaths to come.

In Kenya, a murdered person may become a ngoma, a spirit who pursues their murderer, sometimes causing them to give themselves up to the police. In Russia the rusalka is the spirit of a dead woman who died by drowning and then lures men to their death.

But ghosts are not always vengeful, they can also be friends and protectors. In Charles Dickens' A Christmas Carol, Ebenezer Scrooge is helped by three ghosts to mend his cruel and hard-hearted ways before it's too late. In the film Sixth Sense, a ghost helps a young boy to come to terms with his ability to see dead people.

Many people like to believe that death is not the end of existence. They are comforted by thinking that their deceased loved ones are watching over them. It can also help them face the idea of our own mortality. Most of us



believe that our physical being is separate from our consciousness which means it's not a huge leap for us to entertain the idea that our mind could have an existence separate from our body and thus that our mind or consciousness could survive death. Some people even believe that the dead can communicate with the living through mediums and spiritualism.

It seems our love of the paranormal runs deep and Halloween is the perfect time to indulge.

Perfect Halloween Films

Ghost Films

Casper

Sixth Sense

The Woman in Black

The Legend of Hell House

The Ghost of Mrs Muir

ParaNorman

Personal wrapping • Corporate wrapping
Wedding favours

Banana Leaf

ECO GIFT WRAPPING



Need a helping hand?

info@banana-leaf.co.uk

07842 759266

www.banana-leaf.co.uk

GIFT WRAPPING THAT DOESN'T COST THE EARTH

Keep Pets Safe on Bonfire Night

My Jack Russell terrier Pippa takes Bonfire Night in her stride. but Tess, my mixed breed rescue, transforms into a quivering wreck, who snaps, snarls and once drew actual blood when I tried to fish her out of the tumble drier where she had retreated among the yet-to-be sorted bed sheets.

Studies suggest that almost half of dogs show signs of fear when they hear fireworks. Tess is at the extreme end of the scale and action was clearly required.

There are a few simple things we can do to help a pet deal with fireworks. Some basic preparation will make Bonfire night a less stressful experience for everyone.

For dogs, walk them earlier in the day to avoid times when fireworks are likely to be set off. Close windows and curtains at night so loud bangs are muffled, and play music or put the TV on to further mask firework sounds

Make a doggy den. This is a quiet space where a dog can feel in control. My dogs are crate-trained but the crate wasn't cutting it for Tess who wanted a proper bolthole. She dived in headfirst, and we didn't see her till the following morning, when she re-appeared as though nothing was out of the ordinary!

Cats also need hiding places too, though they are pretty good at finding their own! Try to bring cats inside, even if they normally go out at night, because they can become stressed and disorientated if they're caught outside during a fireworks display.

If you have small animals, covering outside cages and pens with blankets so an area is soundproofed and hidden is a good idea. And provide bedding they can burrow into. If you have a cool room where they can be undisturbed it can be good to move the hutch or cage temporarily inside.

The Dangers of Joint Property

"How is your joint property held?"

Hannah Tait, partner at Shakespeare Martineau in Solihull explains why this is so important when estate planning or making a will.

If you own your home with someone else, there are two ways in which the property can be held: joint tenants and tenants in common.

Joint tenants

Where property is held as joint tenants, on the death of one owner, the property passes automatically to the other, regardless of the provisions of that person's will. Many family homes are held as joint tenants, as this is often seen as the "default" for couples and although this may work well for many people, it is not always the best or most practical option. Consider a second marriage, where the first to die wishes to protect their share of the property for the children of previous relationships. If the home is held as joint tenants, the surviving spouse has complete control after the first death – they could give the property away or they could leave it in their will to their own children or to a new spouse if they remarry. If they die without a will, the laws of intestacy will decide who will inherit this on their death and this will not include step-children.

Tenants in common

Where property is held as tenants in common and one person dies, the share belonging to them passes in accordance with the terms of their will, or if they don't have a will – will pass via the intestacy rules to potentially unwanted beneficiaries. So, if you're an unmarried couple and neither of you has a will, if one person dies, it may be that their share in the house is passed to their family and not the living partner.

How it affects estate planning

Many people choose to include Nil Rate Band Trusts in their wills on the first death, to ring-fence part of the estate of the first to die from care fees if the survivor needed care in the future. Subject to the other assets in the estate, this will only work practically if the property is held as tenants in common and not where property is held as joint tenants. The best option is strictly dependant on individual circumstances so obtain legal advice before committing to one option over another.



For more information and support call 0121 705 1208
email Hannah.Tait@shma.co.uk or visit www.shma.co.uk

Shakespeare Martineau Radcliffe House, Blenheim Court, Solihull, B91 2AA

Belmont @ Home provides bespoke home care services designed to fit perfectly to each individual.



For those who still wish to have their own familiar front door and stay at home safe in the knowledge someone is there to care, Belmont @ Home offers at home care services.

Unlike other home care services, Belmont @ Home care services are not rushed. Every individual benefits from the care team's time, attention, and care, no rushed visits, no clock watching,

just time for dedicated service.

At home care services should adapt to each individual need, mood and daily, weekly plans.

From personal care, organisation of social activities, attending to daily admin, housekeeping and preparing meals, or acting as chaperone to appointments, Belmont @ Home is there to support you!

Belmont @ Home care services flex to each individual because every day is different



Your first step towards personalised home care services starts with a free no obligation conversation with a Trusted Assessor to learn more about you and your needs.

To receive an initial assessment call us on 0121 295 8905



Because every day is different, Belmont @ Home will work to your needs and aspirations.

Join us for tailored home care services uniquely designed for you and your life.

www.belmonthealthcare.co.uk

☎ 0121 295 8905

✉ homecare@belmonthealthcare.co.uk



MIDLANDS
ULTRASOUND
& MEDICAL
SERVICES



MUMS is a **specialist Consultant-led** medical practice based in **Solihull, West Midlands** offering a number of medical services.

The Consultants and GPs at MUMS are proud to offer the highest standard of patient-centred healthcare.



Convenient unrushed appointments

- ✓ No need for a referral from your NHS GP
- ✓ No waiting times
- ✓ Unrushed appointments
- ✓ On site diagnostics

Specialist Consultants
GP's
Diagnostics
Ultrasound
Pregnancy Care

Antenatal Scans
Health Screening
Vaccinations
Sexual Health
Covid Testing

Trusted Excellence in Private Healthcare

Book an appointment with a
member of our dedicated team

Call. 0121 704 2669

Email. administrator@mums.me.uk

Clinic Address

Midland Ultrasound &
Medical Services
1 Park Avenue, Solihull,
West Midlands B91 3EJ



Follow us on Social Media



www.mums.me.uk

LET'S CREATE THE LAWN WE BOTH LOVE

SAVE UP TO
30%
ON OUR ULTIMATE
PROGRAMME*

*Save up to 30% with our Ultimate Programme and up to 18% with our Standard Programme when you pay by Direct Debit.

SAVE UP TO
18%
ON OUR STANDARD
PROGRAMME*

PREPARE YOUR LAWN NOW

Autumn is a very important season for your grass. Lush green lawns in spring don't just appear overnight, the preparation starts now.

Revolutionise your lawn with annual machine work paired with our unique **Spring Ready Treatment** applied from January - working wonders across the nation's lawns.

EVERY LAWN BENEFITS FROM MACHINE WORK

Lawns have a natural build-up of thatch. Thatch creates an environment irresistible to moss. **Aeration** and **Scarification** reduce thatch, thus reducing moss. **Simple!**

Annual machine work is essential for a healthy lawn. Autumn and spring are the best times of year for your grass to benefit from **Aeration & Scarification**. Our **Spring Ready Treatment** will then be waiting patiently for the optimal weather conditions before releasing its nutrients onto your lawn at the best possible time.

FROM JUST

£15

PER TREATMENT**

**Based on 5 core treatments with a lawn size of 40m²

Book your machine work in today - your lawn will thank you for it!

Join our nation of Lawn Lovers today:

Call: 0121 705 6395

Email: solihull@greenthumb.co.uk

Visit: greenthumb.co.uk

GreenThumb
LAWN TREATMENT SERVICE



**Only £895 for
a fully fitted
electric door.**

Gotta get a Garolla.



Garolla garage doors are strong and solidly built. They're made to measure in our own UK factories. The electric Garolla door rolls up vertically taking up only 8 inches inside your garage. Our expert installers will fit your new door and take away the old one so there's no mess.

Give us a call today and we'll come and measure up completely Free.

GAROLLA
ROLLER
SHUTTER
DOORS



GOTTA GET A GAROLLA

NOW ONLY

£895 WAS £1,354
INC VAT

WHAT'S INCLUDED WITH EVERY DOOR:

FREE EXPERT MEASURING & FITTING
TWO REMOTE CONTROLS
ACOUSTIC & THERMAL INSULATION
AVAILABLE IN 21 COLOURS
FREE DISPOSAL OF YOUR OLD DOOR

Offer valid for openings up to
2.6m wide & inc: 2 remote
controls, 55mm white slats,
internal manual override.

CALL US TODAY

01564 340 013

MOBILE

07537 149 128

www.garolla.co.uk

Beech  **Languages**
LOCAL LANGUAGE LEARNING

**LOVE TO SPEAK GERMAN, FRENCH OR SPANISH?
NEW TO SOLIHULL AND NEED BETTER ENGLISH?**

All online courses of 10 hours (including GCSE 'catch-up') now just £299

Expert tuition for exams, travel and business
Local, qualified and experienced language tutors

Contact us now for your free, no-obligation consultation

Call 01564 739621 or 0784 031 5982

E-mail info@beech-languages.co.uk

www.beech-languages.co.uk

LANGUAGE LESSONS LOCALLY AND ONLINE



**Acorn Floors
Ltd.**

Floorcovering Specialists

Providing quality floorcoverings for over 25 years

**Luxury Vinyl Tiles
Carpets
Wet Room Solutions
Floor Refurbishment
Carpet Whipping**



**Karndean
Designflooring**

amtico

POLYFLOR™
COVERING THE WORLD

**The complete
design and
installation service**

10% OFF
with this advert

Free Quotation & Sample Service

acorn-floors.co.uk enquiries@acorn-floors.co.uk

Contact Stephen Sherrington

0121 693 3301 07799 645 709

Dimension Groundworks & Driveways

Specialists in Driveways and Landscaping

- Block paving • Tarmacing (red or black) • Patios
- Brickwork • Slabbing • Gravel • Landscaping
- Fencing • Property & roof repairs
- Driveway maintenance
(pressure cleaning & sealing – weed free)



07961 358367 / 0121 652 0145 / 01926 674782

dimensiongroundworks@icloud.com

www.dimensionpathways.co.uk

328 Alcester Road Wythall Birmingham West Midlands B47 6JR

Bill Boyce Decorators

A family run business with over 30 years experience

- Painting & Decorating
- Internal / External
- Offices, Restaurants & Private Houses
- Reliable
- Excellent Reputation
- All work carried out to a high standard
- Free Estimates



Call Bill on 07976 810680 or Dan on 07966 275134

89 Union Road, Shirley, Solihull, B90 3BY
 Tel: 0121 744 0040 or fax: 0121 744 0312
 Email: billboycedecorators@hotmail.co.uk
www.billboycedecorators.com

C. STEVENS ROOFING

EST FAMILY BUSINESS

NEW TILED ROOFS • GUTTERS
 FLAT ROOFS • BRICK WORK
 LEADWORK • SMALL REPAIRS
 UPVC FASCIAS • CHIMNEYS



KNOWLE

SOLIHULL

01564 790008 0121 733 1276

WWW.CSTEVENSTEROOFING.CO.UK

Bad Teacher!

What to do when your child has issues with their teacher

Most parents worry a little at the beginning of a school year; will the new teacher be a good fit for my child? Usually things work out fine, even if there are a few rocky moments initially. But if problems persist, what is the best way to handle it?

Reading emotional signals isn't easy but as a parent it's usually wise to trust your instincts.

Riding out a year with a difficult teacher can help a child learn resilience and problem-solving. We can probably all remember at

least one teacher with a 'reputation' from our own school days. It requires careful judgement. One child might be able to rationalise (with a little parental support) that harsh criticism says more about the teacher than it does about them,

while another may become anxious and stop enjoying school. You know your child best.

If you feel there might be a problem try to get as much detail as possible. The idea is to get a more concrete sense of your child's viewpoint. Probe gently and casually to avoid causing distress, do make sure that it's not an overreaction to normal teacher behaviour.

Tell your child that you're going to write down what she's saying so you can have a conversation with the teacher. Make it clear that you care about what's happening, and that their concerns are going to be heard, but that you are not going in to make trouble.

If you decide to speak with the teacher, don't try to catch them at drop-off or pick-up time. Book an appointment. Approach the situation as someone seeking help in solving a problem. Use inclusive language and explain

the situation using as many of your child's own words as possible. Saying, 'Can you help me understand why Kiera seems so anxious before school,' is better than 'Kiera says you're mean to her.' This will help not to escalate the situation. Teachers are human though and some are very sensitive. Do your best to reassure them that you're not blaming them. However, you are there to advocate for your child so try not to be derailed if they become defensive. Stay calm and repeat that you're simply trying to understand what's going on.



Ideally, the teacher will shed light on the situation, and you can have a mutually useful conversation that will help them teach your child effectively. But at the very least you'll understand more about how the teacher communicates.

They may be taciturn, or

snarky or perfectly nice but just not very genial. Then you can talk to your child about how some people are not as smiley, or patient as others but they aren't necessarily a horrible person.

Of course, if the meeting doesn't go well you might have to take it higher, maybe to the head of year, or the deputy head. Explain the steps you've taken and stress that you are concerned about your child's education. You might be given the option of another meeting with the teacher, or they might decide to deal with the situation in house. If nothing changes, remain calm, but be firm and make it clear you're not going away. As a last resort request a move to another class.

It's upsetting as a parent to watch your child struggle. But remember, even if the outcome isn't perfect, watching how you deal with things in a calm, rational and encouraging manner will teach them a great life lesson.

Lady Katherine Housing & Care



Rated by the Care Quality Commission as:

GOOD

RESIDENTIAL CARE SHELTERED HOUSING RESPIRE CARE

(now taking Autumn and Winter Respite bookings)

If you would like to pay us a visit or discuss our current availability

contact:

Chris Mundell

on

01564 772415/ 07593 552136



Gone Fishin'

Getting started with fishing

My son loves to be outdoors spending time in the countryside. I told him how my dad and I used to have fantastic fun on

our fishing trips to the various rivers and lakes around the area where we lived. This caught his interest and he asked if we could go fishing. Sounded great me!

Luckily we have a small angling-supply shop in our village, so we popped in to look around and get some advice.

The staff were very knowledgeable and talked us through the equipment choice

for a good quality, but reasonably priced starter set. This consisted of a nice rod suitable for float fishing and spinning, a good quality reel to go with it (don't forget to get some fishing line and ask if the staff can fit it for you!), some floats and hooks for maggot fishing

and some lures for going after pike and perch. A few other bits and bobs and we were ready to catch our first whoppers for under £100.

By this time the staff knew we were novices, so they weren't surprised when we answered their, "Have you got your licences?" question with a puzzled look.

It turns out there are a number of rules and regulations you need to obey if you want to go fishing and stay on the right side of the law.

In England and Wales anyone aged over 13 needs a rod fishing licence. It's free if you're 16 or under and about £30 per year for an adult. In Scotland you just need permission for the place you want to fish from the landowner or angling club. In Northern

Ireland you'll need a licence and a permit for the stretch of water. In Scotland and Northern Ireland some rivers and lakes are controlled by angling clubs, so you'll need to check before you head off to the river.

It's also turns out that you can't just fish whenever you want. Rivers in England and Wales have a close season from 15th March to 15th June. Scotland and Ireland also have close seasons with most being controlled by the angling clubs that own the fishing rights, so again make sure you check with them.

Some rules do get a bit complicated with different fish having close seasons, and

certain types of bait being allowed only in certain locations and at certain times, but don't be discouraged. Check out the gov.uk website or have a chat with your local angling club. They will be more than happy to help.

If you're fishing for pleasure you'll most likely put any fish you catch back into the water - obviously taking loads of photos before you do! But if you do plan on keeping some fish for eating there are a number of regulations on your catch sizes. These cover both the minimum size of the fish and the number. It varies from region to region so make sure you check out the rules for the place you want to fish.

With a little research you can feel reassured that your fishing trip won't end in a fine. As for our first trip out; no luck with the bigger pike and perch but some great fun with the smaller fish using a float and maggot. Not exactly whoppers, but we can always try again next time.



ARE YOUR WINDOWS READY FOR A MAKEOVER?

New glass in your existing windows

- Replace failed double glazing; just the pane, not the frame

- Fix faulty hinges, handles and locks

A local family-run business with 10+ years of experience



Call **0800 048 5223** for a FREE Quote

Or visit **ClearlyBetterWindows.co.uk** to find out more

PSYCHOLOGICAL THERAPY. PRIVATE HEALTH CARE.

Equanimity CBT provides Cognitive Behavioural Therapy (CBT) which is the therapy of choice in the NHS for common emotional, behavioural and mental health problems. It is also available privately and through health insurance. Corporate referrals are also accepted.

Work related stress? Anxiety? Depression? Low self esteem? Compulsive behaviours? OCD? Anger management? Emotion regulation difficulties? Adolescent behavioural problems? Aggressive driving? Panic attacks? Phobias? Emotional distress?

Equanimity CBT

New Street, Kenilworth.
Wassell Grove Lane, Hagley.
Day and Evening Appointments Available

Contact: enquiries@equanimitycbt.co.uk
Telephone 0844 693 1282 for a
free 15 minute telephone consultation.

B.A.B.C.P. Accredited CBT Psychotherapist.



Approved Health Care Provider for
AXA-PPP, Aviva, BUPA, Allianz, CIGNA, Simply Health and WPA.

www.equanimitycbt.co.uk

Athos

solutions for the future...

BUSINESS SOLUTIONS

Chartered Certified Accountants

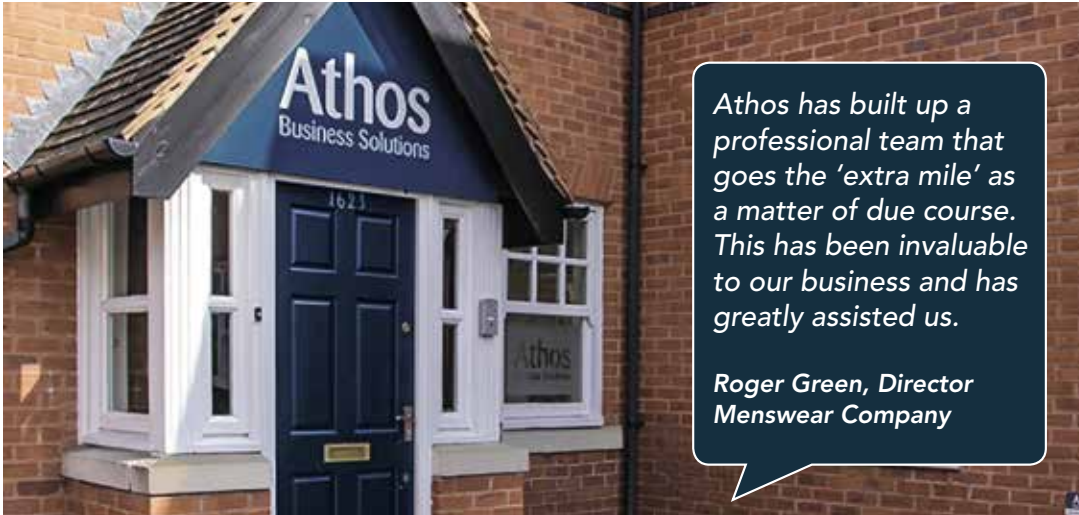

Athos has built up a professional team that goes the 'extra mile' as a matter of due course. This has been invaluable to our business and has greatly assisted us.

**Roger Green, Director
Menswear Company**

- Accounts
- Tax Returns
- Payroll and Auto Enrolment
- Bookkeeping and VAT Returns
- Tax Advice
- Management Accounts



Call and make an appointment for a free initial consultation where a bespoke fixed fee quotation will be provided.

T. 0333 400 7876

Athos Business Solutions Limited

1623 Warwick Road, Knowle, Solihull, West Midlands B93 9LF

www.athos.uk.com

enquiries@athos.uk.com



TAILORED HOME INSURANCE RIGHT DOWN TO THE FINEST DETAIL

Are you 100% happy with your current home insurance? Does the level of personal service you receive meet your expectations?

Because if not, you might like to consider NFU Mutual.

From our offices in Henley-in-Arden and Stoneleigh, we're uniquely placed to have a real conversation about your requirements.



So, for a truly personal approach to insuring your high-value property and contents, including valuables, fine art and collections, call Ross Chatterton at NFU Mutual Central Warwickshire on 01789 333228 or email Ross_Chatterton@nfumutual.co.uk



a good read

reviews By Willow Coby

Ghost Story

by Peter Straub

Although Straub had written a couple of novels before this, this was the book that made his name. It was written in the late seventies, and is an epic creeping horror that has influenced many other writers, including Stephen King. It is set in a small fictional town, where the elderly members of The Chowder Society meet regularly to tell each other spooky stories over a few drinks. The book opens with a seemingly unconnected tale and then the death of one of the group members. Each of the remaining members begins to experience similar, nightmarish, dreams. Contacting the nephew of their dead friend, they find he also has something to contribute to their shared nocturnal visions, forcing them to explore people and events from their collective past—a past they'd much rather forget. The novel, although good in its own right, is also a tribute to ghost stories in general. Straub obviously set out to pay his respects to the genre and there are nods to Nathaniel Hawthorne and M.R James among others. There's a main overarching plot that incorporates a few shorter stories. Straub was clearly having fun, and he includes most of the ingredients for a classic scary story. It's not fast paced but the tension builds nicely, and a real sense of menace develops as Straub draws all the threads together for the climax. It's a must for fans of all things scary. The storytelling is superb and it's definitely good read for Halloween.



In the Night Kitchen

by Maurice Sendak

Another book from the Seventies, In the Night Kitchen is not as well-known as Sendak's other dreamscape, Where the Wild Things Are, but is every bit as magical, with beautiful illustrations.

The story is a fragmented, comic book romp through a child's dream. A stream-of-consciousness, random, quirky, child's-eye-view of the world, set in a sort of kitchen-cum-cityscape built from giant boxes of baking ingredients. Written in a poetic meter that stretches and contracts with the ebb and flow of the action, it's almost as much fun for an adult to read as for a child to listen. My kids (aged 5 and 3) love it, but I will issue a nudity warning to those parents who may not appreciate some of the illustrations. The little boy Mickey is naked for most of the book, which my three-year-old finds utterly hilarious for some reason. My husband had no problem with the nudity, but he wasn't fond of the Oliver Hardy look-alike bakers, proving that even Sendak can't please everyone. Giant milk bottles, planes made from bread: for me, Sendak is a master storyteller who doesn't talk down to his audience. It's highly stylised and like Where the Wild Things Are it feels slightly of its time, but that doesn't matter; the kids feel a mixture of intrigue, excitement, trepidation, and wonder - it's perfect storytelling.





Why not invest in a new driveway or patio to enhance the appearance and add value to your property?

Approved Drives and Landscapes offer a range of services to help improve all areas of your home, including:

Clay & Block Paving - Tarmacing (red or black) -
Patios - Brickwork - Slabbing - Gravel -
Landscaping - Fencing - Property Repairs
Roofing Repairs - Driveway Maintenance
(Pressure cleaning & sealing - weed free)

Proud member of



Find us in/on

Google



www.centraldrivewayslimited.com

Get in touch today for a FREE quotation

T: 0121 702 1456 M: 07748 577687

Michael.central@icloud.com



COMPETITION

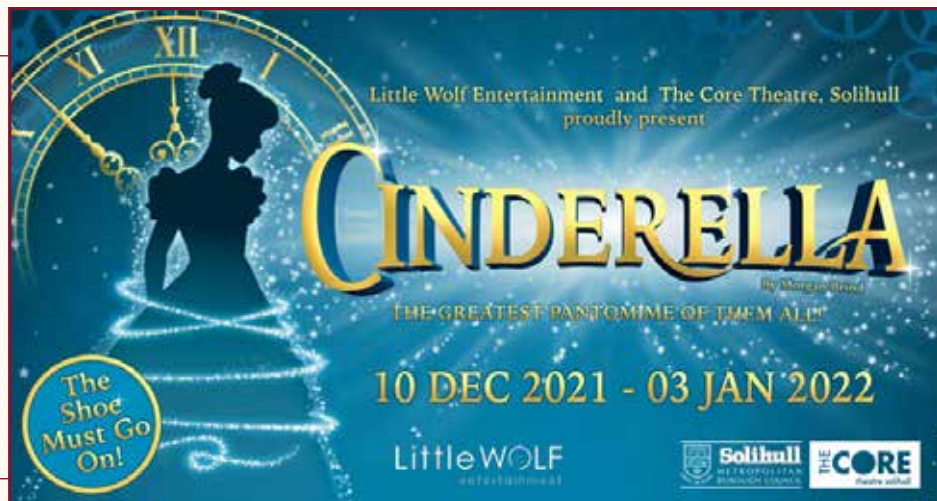

Win a family ticket

to see

Cinderella Pantomime

at Solihull's Core Theatre on Friday 10 December at 7pm

For your chance to win these tickets, visit the Core Theatre website page for this event - www.thecoretheatresolihull.co.uk - to find the answer to this question:

What's the last date of the pantomime?

Email your answer to: thecoretheatre@solihull.gov.uk - and please put '**Cinderella**' as the subject line.

Closing date for entries is 10th November.

The winner will be drawn at random and notified by email after this date.

Please note there is no cash value nor exchange for this prize so please don't enter if you cannot attend the date shown above.

About the show:

Doomed to drudgery by her wicked stepmother and spiteful stepsisters, Cinderella dreams of escape and romance. Meanwhile King Keith of Kings Heath is making plans for a royal ball. It's going to take all the magic her Fairy Godmother can muster to whisk Cinders from pantry to palace by pumpkin, but with her stepsisters digging their ugly heels in, it's not an easy ride to happy ever after. Featuring sparkling sets, fabulous frocks, side splitting slapstick and not one, but two outrageous dames, this is an unmissable treat for the whole family. The clock is ticking so grab your tickets to the ball now! After all... the shoe must go on!

Dorridge & Knowle Domestic Cleaning Services

- Small established cleaning and domestic help business
- Provide dedicated, friendly & trustworthy local ladies (*CRB checked*)
- Take pride in high standards and caring for customers' homes
- Regular service or one off spring cleans
- Ironing service available
- References available
- Comprehensive insurance
- Costs are not subject to VAT



For a FREE, no obligation quote,
please call Sue on 07809 567264

**Help make a world of difference...
Become a CAREGiver today!**

Home Instead Solihull

01564 330 395 | 01212 704 615

www.homeinstead.co.uk/solihull

Each Home Instead® franchise office is independently owned and operated. Copyright © Home Instead 2017.

 **Home
Instead.**
To us, it's personal



**STU'S LOFT
LADDERS**

FREE

No Obligation Quote
10 year Manufacturer Warranty

Installing Loft Ladders Since 2008

All types of loft ladders professionally installed.

Top quality 3 section aluminium loft ladder professionally fitted with pivot arm, hand rail, wide flat treads for comfort and rubber feet. Loft hatch included.

ZARGES

YOUNGMAN
ALUMINIUM LADDERS AT BIRMINGHAM COLLECTION

ABRU

manthorpe
building products

We also install loft flooring and boarding

Areas that we cover?

- Redditch • Solihull • Stratford-Upon-Avon
- Worcester • Warwick • Birmingham • Evesham

Tel: 01527 850295 • Mobile: 07712 327889
stuart@stusloftladders.co.uk • www.stusloftladders.co.uk



CROSSROADS SERVICE STATION LTD

A friendly, family-run business since 1969

- MOT Testing – Cars & Motorbikes
- Servicing & Repairs
- Air Conditioning Service & Repair
- Diagnostic Service & Repair
- Laser Wheel Alignment
- Tyres – Supplied & Fitted
- Qualified & Experienced Staff
- Courtesy Car or Collection/Delivery available

**OPEN 6 DAYS
A WEEK**

MON – FRI 8.00am – 6.00pm
SAT 8.00am – 1.00pm

COVID SECURE

VOSA  RMI

599-601 Tanworth Lane, Shirley, Solihull B90 4JE

Tel: 01564 703225

www.crossroadservicestation.co.uk

VAT No.: 113213041

Boost your immune system

As the flu season rolls around again, and we are now dealing with the additional threat of COVID-19, we need to take care of our immune systems.

There are two main parts to the immune system: the innate immune system is the one you are born with, and it is the body's rapid response system, working to attack antigens or invaders, while the adaptive or acquired immune system builds antibodies to protect your body from certain microbes, or germs, it encounters in the environment. Our immune system keeps track of every germ it has ever defeated, so it's primed to be more effective if it encounters the same one again.

Vaccines are great at priming the immune system giving our bodies a head start when it comes to fighting certain diseases, so if you are able to receive the

flu or COVID vaccines it's a no-brainer.

But even if you can have the vaccine, not everybody produces the same immune response so is there anything else we can do to pep up our beleaguered immune system at this time of year?

Elderberry - Sambucus nigra consists of many vitamins and minerals which boost immune health.

Vitamin C - Vitamin C is required for white-cell production. The body can't make vitamin C, so a supplement is very useful.

Zinc - Helps produce new immune system cells in your body.

Vitamin D - Helps to regulate the immune system.



No call-out charge
Available 24/7

JUST
MOVED IN?
CALL US
FOR NEW
HOME
PACKAGES

CALL TODAY FOR A FREE, NO-OBLIGATION SECURITY CHECK AND ADVICE

Locked Out

We can gain access for you non-destructively

Emergency Locksmiths

15-30 min emergency response time for your peace of mind

uPVC Door Lock Specialists

Our locksmiths are specialists in uPVC door and window locks

Door/Window Handles Changed & Replaced

Stuck, broken or damaged window handles? We can help

Lost Keys

Lost your keys? We recommend a full lock change service for your security

Locks Changed & Replaced

Lock replacement and upgrades, all with a 12 month guarantee

Home Security

We offer a variety of smart camera and alarm systems to protect your property

Emergency Boarding Up & Burglary Repairs

We can offer a 24/7 emergency boarding up and repair service



12 month parts
& labour guarantee



lewis@lockfit.co.uk
www.lockfit.co.uk/lockfit-locksmiths-knowle/

01564 627 020

Pumpkin Pie Perfect for Halloween



Preparation time: 40 minutes

Cooking time: 1 hour 40 minutes + chilling time

Serves: 8

Ingredients

750g pumpkin or butternut squash, peeled, deseeded, and cut into chunks
350g sweet shortcrust pastry (make your own or buy ready-made)
140g caster sugar
½ tsp salt
½ tsp fresh nutmeg, grated
1 tsp cinnamon
2 eggs, beaten
25g butter, melted
175ml milk
1 tbsp icing sugar

Method

Place the chopped pumpkin into a large saucepan, cover with water and bring to the boil. Cover with a lid and simmer for 15 mins or until tender. Drain and allow to cool. The final

colour of your pumpkin filling will depend on the colour of the squash you choose. Some have a more yellow flesh, like butternut squash and others like the winter squash have a much more orange flesh. They will both taste equally good! Preheat the oven to 180C/160C fan/gas 4. Roll out the pastry on a lightly floured surface and use it to line a 22cm loose-bottomed flan tin. Chill for 15 mins. Line the pastry with baking parchment and baking beans, then bake for 15 mins. Remove the beans and parchment, then bake for a further 10 mins until the base is pale golden and biscuity. Remove from the oven and allow to cool slightly. Increase oven temperature

to 220C/200C fan/gas 7. Push the cooled pumpkin through a sieve into a large bowl to make a puree. In a separate bowl, combine the sugar, salt, nutmeg and half the cinnamon. Lightly beat together the eggs, melted butter and milk, then add to the pumpkin purée and mix well. Pour the mixture into the tart shell and bake for 10 minutes. Reduce the temperature to 180C/160C fan/gas 4 and continue to bake for 35-40 mins until the filling has just set. Remove from the oven and allow to cool before removing the pie from the tin. You can Mix the remaining cinnamon with the icing sugar and dust over the pie or decorate in a suitably spooky style.

Do you want to grow your business?

If you want to meet more prospects, gain referrals, and network with other local businesses, then join the Knowle & Dorridge BOB Club.

We meet for an hour every 2 weeks (online currently) to exchange information, swap ideas, and help each other generate more business.

There's no pressure to give referrals or provide substitutes if you can't make a meeting, it's friendly and informal, and incredibly supportive.

Join our next meeting for free. To try BOB for yourself, and meet other like-minded local businesses visit:

www.bobclubs.com/Club/Knowle

Or contact

Patrick on 07490 645665

patrick@yourfinancefriend.co.uk



Join thousands of business owners around the world

at a local club that's part of one of the World's largest business networking organisations.



“Improving the way you get business”

Great news for travel



The latest travel update took place on 17th September 2021, with positive changes taking place for holidaymakers!

From 4th October

The current traffic light system of red, amber and green countries will be scrapped and replaced with one red list only. Also from that date, travellers will no longer need to take pre-departure tests for travelling into England from abroad.

End of October

Then, from the end of October, fully vaccinated passengers from non-red list countries will be able to replace day-two PCR tests with lateral flow tests.

Countries removed from Red List

The government has also announced that from 4am on 22 September, eight destinations will be removed from the red list.

The destinations are:

Turkey
Pakistan

The Maldives

Egypt

Sri Lanka

Oman

Bangladeshi

Kenya

If you're looking to get away, get in touch with your Personal Travel Consultant today!

Sabina Clay

Not Just Travel

sabina.clay@notjusttravel.com

07565 534 524





NOT JUST TRAVEL

HOLIDAYS
MADE Better

Choice • Service • Value

ENQUIRE NOW

Any trip • Anywhere • Anytime • Tailor-made

Honeymoons - Cruises - Adventure Packages - Flights
Hotels - Extras - Airport Car Parks - Weddings Abroad



Sabina Clay
Not Just Travel
sabina.clay@notjusttravel.com
07565 534 524

ABTA
Travel with confidence



WINDOW FIX of SOLIHULL

DOUBLE GLAZING REPAIRS & INSTALLATION

- Misted/Broken glass units
- UPVc-DoorLocks/Hinges/Handles
- Windows-Locks/Hinges/Handles
- Patio Door-Tracks/Wheels
- Conservatory Roof Replacement
- Replacement Fascia & Guttering
- REPLACEMENT WINDOWS & DOORS

0121 704 1339

www.windowfixofsolihull.co.uk



DMC PLUMBING

For all your plumbing requirements
from small leaks to full
bathroom refurbishments.

- All work guaranteed
- 24 hour emergency call out
- Established over 25 years.

Contact Dave on:

07792 296728
01564 772 876



Suffering from increasing joint pain, aches and stiffness?

Come and try a innovative movement
programme that helps to restore
movement ease and vitality

Monday 9.45am level 1-2

Thursday 6.30pm level 1-2

**St George St Teresa Parish Centre,
Station Road Dorridge**

To find out more call 0776 2311 074

Visit www.freedomwithmotion.com

All the more reason to find a mat and book today.

Tidy up Time

By October the garden can look a little tired: perennials collapse, leaves die back, and there's debris everywhere. It can only mean one thing, clean up time.

Cut Peonies, Leucanthemum, Nepeta, Delphiniums, Hardy Geraniums, and Phlox back to ground level, but leave anything with ornamental seed heads such as poppies, Alliums, and grasses. When the first frosts hit these plants will gain a new lease of life and add some sparkly architectural beauty to the garden.

Leave more delicate perennials such as Penstemons with the top growth in place to provide some winter protection. You can cut them back in the spring just before new growth occurs.

Herbaceous perennials can be divided now and moved around to fill gaps in the border. Perennials can become congested and tired, and flower less as they age. Dig up the clump and break it up with a sharp spade, selecting the best, newer chunks from the outside to replant. The dying centre of

the plant can be composted. Most plants need to be divided every three to five years but some more vigorous varieties like Achillea require it more often and others. The exception is Peonies, which hate any kind of disturbance. Leave them alone.

Once the borders are cleared and plants have been relocated, it's time to get rid of any weeds, which have flourished in the autumn sunshine. Then you can mulch using compost or leaf mould. Mulching helps to protect the more tender plants while improving the structure of the soil and generally making things look neater. Make a layer around 3-4cms deep but don't cover the centre crown of any plants.

Types of organic mulch

- Compost
- Bark
- Grass cuttings
- Composted manure
- Newspaper
- Shredded Leaves
- Straw





EASTCOTE
PARK
CINNAMON LUXURY CARE

ESTATE
AGENT FEES
COVERED*



THE PERFECT PLACE TO ENJOY LUXURY RETIREMENT

Enjoy companionship, safety and a vibrant community at Eastcote Park Retirement Village. Situated in a stunning rural setting in the heart of England close to the historic market town of Solihull. Our retirement village boasts 34 luxuriously appointed, spacious 2-bedroom apartments. With extensive on-site amenities, a comprehensive social activities calendar, transport services and much more, you will have plenty of time to enjoy life.

For more information or to arrange a personalised tour please call our Team on 01564 757237 or email eastcote.enquiries@cinnamoncc.com

- ❖ Ground & First Floor Apartments
- ❖ Private Lifts for all First Floor Apartments
- ❖ Piano Bar, Restaurant and Private Dining
- ❖ Fitness Studio
- ❖ Hair & Beauty Salon
- ❖ Emergency Call System to 24-hour On-Site Team
- ❖ Boutique Care Home

Eastcote Park Retirement Village & Care Home Knowle Road, Eastcote, Solihull B92 0JA

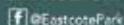

@EastcotePark

www.cinnamoncc.com/eastcote

* Terms and conditions apply.

crossword

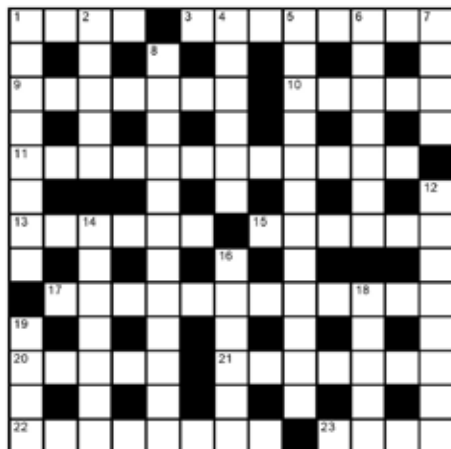

clues

Across

- 1 Cure, restore (4)
- 3 Despite, notwithstanding (8)
- 9 Theft, burglary (7)
- 10 Lizard with sticky feet! (5)
- 11 Fall heavily (coll.) (4,1,7)
- 13 Bulging belly (6)
- 15 Crackpot, oddball (6)
- 17 Fungal disease of the toes (8,4)
- 20 Hard outer layer (5)
- 21 Unblemished (7)
- 22 Discuss yet again (8)
- 23 Cut (4)

Down

- 1 Printout (4,4)
- 2 Scrapbook particularly for photos (5)
- 4 Tiers (6)
- 5 Intense strain or tension (4-8)
- 6 Hazy (7)
- 7 An owl's cry (4)
- 8 Does the sums again (12)
- 12 Pace, stride (8)
- 14 Lie (7)
- 16 Necessary, basic (6)
- 18 Large body of water (5)
- 19 Defect, disfigurement (4)

answer on page 45

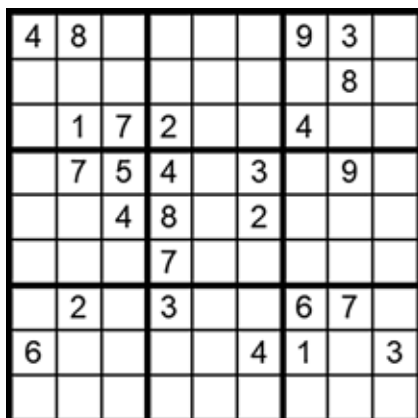

how to play sudoku

It's simple!

Fill in the grid so that each row, column and 3x3 box, contains the numbers 1 through to 9 with no repetition. You don't need to be a genius. These puzzles use logic alone. Watch out! Sudoku is highly addictive.

answer on page 45

WESTBRIDGE ROOFING & BUILDING

LET'S TAKE YOUR HOME TO THE NEXT LEVEL



Our family has been in the building and roofing trade for over 50 years gaining trust and experience along the way.

All services are tailored to your needs, and we can't wait to help you transform your home!



FREEPHONE:

0800 037 0122

Unit 35, 64 Marshall Lake Road, Solihull B90 4PL

Website: www.west-bridge.co.uk | Email: westbridge1@hotmail.co.uk

Does your company
need a **fresh approach**
to marketing?



hotlobster design offers everything a
business needs in this **digital world**.

Bespoke content managed websites, SEO, social media management,
print management, logo design, clothing, copy writing and much more.

hotlobster 
design • marketing • web • print

0121 369 1977

www.hotlobster.uk.com

Does your website
look old, dated and you're
not sure what to do?



hotlobster design offers you up-to-date
websites to replace your tired ones.

Bespoke content managed websites are cheaper than you think.
Call now for a chat about your website, social media & marketing needs.

hotlobster 
design • marketing • web • print

0121 369 1977

www.hotlobster.uk.com

useful numbers

Health

NHS non-emergency	111
Dorridge Surgery	01564 776262
Knowle Surgery	0121 796 2777
Solihull Hospital	0121 424 2000
Spire Parkway Hospital	0121 704 1451
Daleswood Health, Solihull	01675 489489

Council

Solihull Council	0121 704 6000
------------------	---------------

Utilities

Electricity power cut	0800 6783 105
Gas leak	0800 111 9999
Severn Trent Water	024 7771 5000
Severn Trent Water (emergencies)	0800 783 4444

Travel

National Rail Enquiries	03457 48 49 50
Network West Midlands (buses)	0345 303 6760

LOCAL COUNCILLORS

DORRIDGE & HOCKLEY HEATH

Ian Courts

Tel: 01676 535490
icourts@solihull.gov.uk

Andrew Mackiewicz

Tel: 01564 230294
amackiewicz@solihull.gov.uk

Ken Meeson

Tel: 01564 777772
kmeeson@solihull.gov.uk

KNOWLE

Diana Holl-Allen MBE

Tel: 01675 443112
dhallen@solihull.gov.uk

Jeff Potts

Tel: 01564 774804
jpotts@solihull.gov.uk

Alan Rebeiro

Tel: 01564 200047
arebeiro@solihull.gov.uk

local police contact for knowle & dorridge

Sergeant Mike Lloyd

Telephone: 101 ext 892 6037

Email: rural@west-midlands.pnn.police.uk



Accountants

26 Athos Business Solutions 0333 400 7876

Bathrooms and Kitchens11 Cullen Plumbing
& Tiling 07896 862916**Blinds and Curtains**

7 Hillarys 07738 990211

Builders41 Westbridge Roofing
& Building 0800 037 0122**Builders' Merchants**

46 EH Smith 0121 713 7100

Business Networking

35 Knowle BOB Club 07490 645665

Car Services32 Crossroads Service
Station 01564 703225**Care services**15 Belmont @ Home Care 0333 444 0121
23 Lady Katherine Housing
& Care 01564 772850
31 Home Instead 01564 330395
39 Eastcote Park 0121 269 1236**Carpets & Flooring**19 Acorn Floors 0121 693 3301
47 D.A. Mander & Son 01564 700200**Cleaning Services**31 Dorridge & Knowle
Domestic Cleaning
Services 07809 567264**Doors and windows**7 ACS Doors 07592 303104
18 Garolla garage doors 0121 369 0774
25 Clearly Better Windows 0800 048 5223
37 Window Fix 0121 704 1339**Estate agents**

48 DM & Co 01564 777314

Funeral directors

2 Bastock & Bruce 01564 335577

Gardens and drives8 Oakland Group 01564 758608
10 Solihull Tree Care 0121 604 6809
17 Green Thumb 0121 705 6395
20 Dimension Landscape
& Driveways 0121 733 1463
29 Central Drives
Landscapes 0121 702 1456**Gift wrapping**

13 Banana Leaf 07842 759266

Graphic and Website Design42-43 Hot Lobster
Design Ltd 0121 369 1977**Health and wellbeing**25 Equanimity CBT 0844 693 1282
37 Central England Pilates 07762 311074**Heating**9 Stephen Smith Plumbing
& Heating 01564 200119**Insurance**

27 NFU Mutual 01564 792215

Languages

18 Beech Languages 01564 739621

Locksmiths

33 Lockfit 01564 627020

Lofts

32 Stu's Loft Ladders 07712 327889

Medical services

16 MUMS 0121 704 2669

Mortgages

5 Mortgage Brothers 07531 047301

Painter & Decorator

21 Bill Boyce 0121 744 0040

Plumbing3 Knowle Domestic
Appliance Repairs 01564 730183
9 Stephen Smith Plumbing
& Heating 01564 200119
11 Cullen Plumbing
& Tiling 07896 862916
37 DMC Plumbing 07792 296728**Roofing**1 N. Bird & Son 0121 743 6324
9 React Roofing 07922 230477
21 C Stevens Roofing 0121 733 1276
41 Westbridge Roofing
& Building 0800 037 0122**Solicitors**14 Shakespeare
Martineau 0121 705 8151**Tiling**

11 Cullen Plumbing & Tiling 07896 862916

Travel Agent

37 Not Just Travel 07565 534524

4	8	2	5	6	7	9	3	1
5	3	6	1	4	9	7	8	2
9	1	7	2	3	8	4	6	5
8	7	5	4	1	3	2	9	6
3	6	4	8	9	2	5	1	7
2	9	1	7	5	6	3	4	8
1	2	9	3	8	5	6	7	4
6	5	8	9	7	4	1	2	3
7	4	3	6	2	1	8	5	9

Sudoku Solution

from page 40

H	E	A	L	A	L	T	H	O	U	G	H
A	L	R	A	I	N	O					
R	O	B	B	E	R	Y	G	E	C	K	O
D	U	C	E	H	L	T					
C	O	M	E	A	C	R	O	P	P	E	R
O			L	S	R	A	F				
P	A	U	N	C	H	W	E	I	R	D	O
Y	N	U	S	S							
A	T	H	L	E	T	E	S	F	O	O	T
S	R	A	A	U	C	S					
C	R	U	S	T	P	E	R	F	E	C	T
A	T	E	L	E	A	E					
R	E	H	A	S	H	E	D	S	N	I	P

crossword Solution

from page 40

Now Open



Visit our new showroom today for
new and innovative styles and trends to
update your kitchen or bathroom.

Symphony®

ROT
PUNKT
KÜCHEN

LAURA ASHLEY
PREMIUM COLLECTION

Utopia

MACKINTOSH®

NEFF

 **EH Smith**
**KITCHENS &
BATHROOMS**

 127 High Street,
Henley-in-Arden, B95 5AY

 0121 713 7270

 info@ehsmith.co.uk

D.A. MANDER & SON Ltd

PROFESSIONAL FITTER AND
SUPPLIER OF QUALITY CARPETS

*Don Mander does not have retail premises. If you need him
please call him direct – the only way to buy carpets*



Need a carpet?

Support the NHS
Stay at home and stay safe

We come to you

ACCURATE
*See colours in their
true light*

CONVENIENT
*View in the comfort of
your own home*

EASIER
*Than walking round
lots of shops*

01564 700200

We can uplift and remove existing carpets and move furniture

Mobile: 07976 778694
FREE ESTIMATES

91 Longdon Road, Knowle B93 9HT

See our Review's at

Google



Yell

FreeIndex

WISHING TO

MOVE HOME IN

THE NEAR

FUTURE?

Perhaps now is the time to make
that decision?



CALL US WHEN YOU'RE READY ON

01564 777 314